

# APOLLO

## TRACK LIGHTING

### TRACK FIXTURE



The APOLLO is an elegant approach for a linear wall wash track fixture and is perfect for your project space whether than be a clothing boutique, walkway, or gallery. Available in 1 or 2 feet lengths, multiple CCT and finish options, the Apollo stands out against its competitors.

eralux®



DATE

PROJECT NAME

TYPE

QTY

ORDERING  
CODE

AE-TL-AP

FT12FLP

### OPERATING & ELECTRICAL

INPUT VOLTAGE 120V

POWER FACTOR 0.9

DIMMING Triac dimming

TOTAL HARMONIC  
DISTORTION(THD) <20%

### PERFORMANCE

LEMENS PER WATT 85-90 LPW at 90CRI

POWER  
CONSUMPTION 30W, 60W

DISTRIBUTION Linear Flood Wall Wash

BEAM ANGLE 100°

### MECHANICAL & HOUSING

HOUSING Die casting aluminum for increased rigidity and strength

LENS Highly durable polycarbonate and high transmittance lens

FINISH Black, White, Silver

POWER SUPPLY Factory wired electronic LED driver

LED BOARD COB

### APPLICATION CONDITION

AMBIENT TEMPERATURE  
RANGE -10 °C to 35°C

### COMPATIBLE MOUNTING

MOUNTING

Juno  
Global  
Halo  
Lightolier

### WARRANTY

#### SYSTEM WARRANTY – 5 YEARS

Eralux will warrant defective drivers, LEDs and boards for 5 years from the date of purchase. This warranty is valid only if the fixture is installed and used as per installation guides and specifications. If a defect is present, Eralux will send drivers and boards at no fee with a thorough replacement instructions along with instructions on the return of the defective parts back to Eralux.

#### LUMEN MAINTENANCE – L70 at 50,000 hours

Rated for 70% initial lumen output at 50,000 hours of operation, operated at 25°C ambient temperature; per guidelines published by the Illuminating Engineering Society (IES)

# eralux®

# APOLLO

## TRACK LIGHTING

Track Fixture

DATE						
PROJECT NAME						
TYPE						
QTY						
ORDERING CODE	AE-TL-AP		FT12FLP			

## ORDERING GUIDE

EXAMPLE: AE-TL-AP1FT12FLP30J1BK

FIXTURE FAMILY	LENGTH		INPUT VOLTAGE	DISTRIBUTION	CRI	CCT	ADAPTER	FINISH
AE-TL-AP		FT	12	FL	P			
AE-TL-AP ERALUX Apollo Series linear wall wash track light	1FT 1 foot linear fixture		12 120V	FL Flood light wall wash distribution 100° 30 watts: 2250 lumens at 90CRI 3000K CBCP: 1900 @ 90 CRI	P Premium 90 CRI	27 2700K CCT	J1 Juno mounting system	BK Black powder coat finish
						30 3000K CCT	G1 Global mounting system	WH White powder coat finish
	2FT 2 feet linear fixture			35 3500K CCT		H1 Halo mounting system	SV Silver powder coat finish	
								40 4000K CCT

## PRODUCT DIMENSIONS (in mm)

AE-TL-AP1FT12XXXXXX1XX  
Weight: 1.27 kg

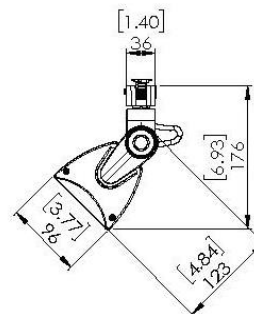
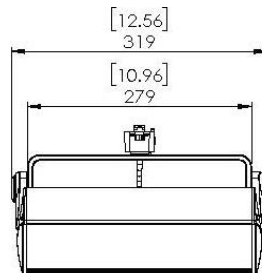

AE-TL-AP2FT12XXXXXX1XX  
Weight: 2.20 kg

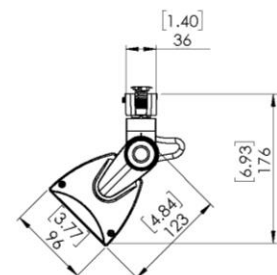
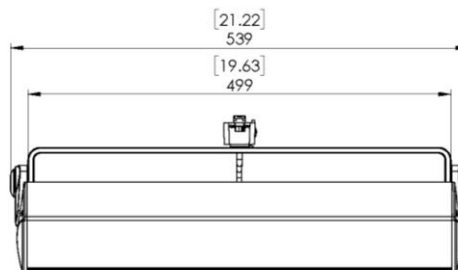

# eralux® APOLLO

## TRACK LIGHTING

Track Fixture

DATE					
PROJECT NAME					
TYPE					
QTY					
ORDERING CODE	AE-TL-AP		FT12FLP		

## LUMEN ESTIMATE

Lumen output varies based on CCT and CRI. An estimate of lumen output of the various CCT/CRI combinations, use correction factors as per table below:

LUMEN ESTIMATE ADJUSTMENT FACTORS			
CCT	2700K	3000K	4000K
PREMIUM (90CRI)	0.96	1	1.06

## PHOTOMETRIC DATA

AE-TL-AP2FT12FLP30X1XX

ZONAL LUMEN SUMMARY			POLAR LUMINOUS INTENSITY GRAPH
ZONE	LUMENS	% OF FIXTURE	
0-20°	358.15	14.70	
0-30°	747.79	30.80	
0-40°	1197.8	49.30	
0-60°	2011.68	82.70	
0-80°	2387.61	98.20	
0-90°	2404.37	98.90	

## DIMMER COMPATIBILITY LIST

AE-TL-AP1FT & AE-TL-AP2FT

TRIAC/ELV Dimmer @120VAC
Lutron S-603PG
Lutron DVELV-303P
Lutron CT-103P
Leviton IPI06-1LZ
Lutron SELV-300P
Cooper SLC03P
Leviton 6631-2
Leviton 6683-IW
Leviton IPE04
Lutron S-600P
Cooper DLC03P
Cooper DAL06P

TRIAC/ELV Dimmer @120VAC
Lutron DVCL-153P
Leviton 6161
Lutron MAELV-600
Lutron DV-600P
Leviton 6633-P
Lutron FAELV-500
Lutron TGCL-153P
Lutron TG-600P
Lightolier ZP260QEW
Leviton VPE06
Lutron LG-600P

0-10V Dimmer @120VAC
Lutron, Diva series (part number DDTV)
Lutron, Nova series (part number NFTV)
Leviton, IllumaTech series (part number IP710-DL)

DATE						
PROJECT NAME						
TYPE						
QTY						
ORDERING CODE	AE-TL-AP		FT12FLP			

## OVERVIEW

### MULTIPLE MOUNTING ADAPTERS

Choose from any of the popular track systems such as Juno, Halo, or Global

### PAINT FINISH

Factory standard in black, white, and silver. Contact for custom paint finishes to enhance your fixture to suit your project space.

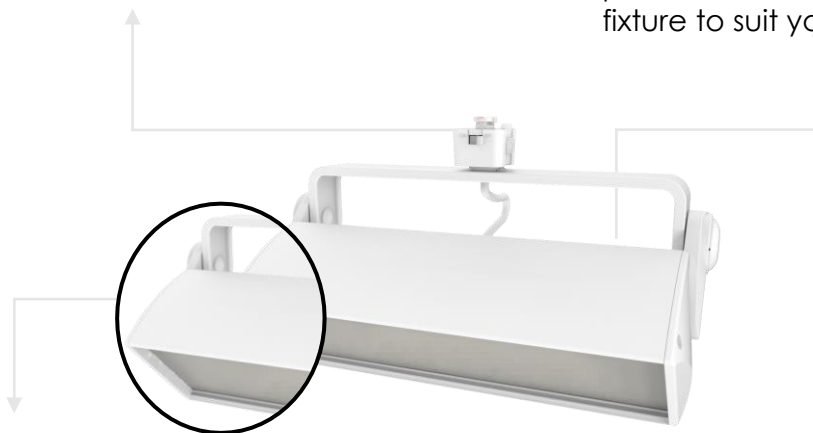

### VALUE ENGINEERED DESIGN

Made from aluminum die-cast to provide excellent thermal heat dissipation and fixture strength. Diffuser structure acts as both a visual shield from light source and heat sink.

### MULTIPLE SIZES

Available in 1, and 2FT length options providing packages from 2250 to 5100 lumens.

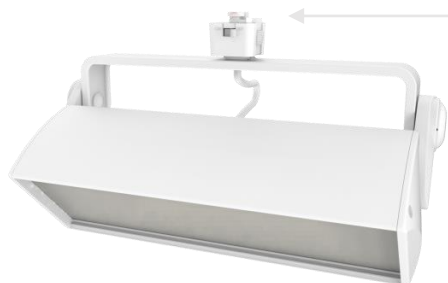

1 FT



2 FT