

# EXITA SERIES

EMERGENCY LIGHTING

EXITA CR-7082RX



eralux<sup>®</sup>



The CR-7082RX has long life high intensity LEDs, it is encased in a fire-resistant thermoplastic ABS housing, while performing in damp locations

DATE	
PROJECT NAME	
<b>TYPE</b>	
QTY	
ORDERING CODE	<b>CR-7082RX</b>

## OPERATING & ELECTRICAL

INPUT VOLTAGE 120/277 Vac

INPUT RATING 1.2W, 100mA

## PERFORMANCE

POWER CONSUMPTION 1.2 W

RUN TIME ON BATTERY 90 mins

LAMPS 2 X 1.2W fully adjustable lamp heads

## MECHANICAL & HOUSING

HOUSING Injection-molded Thermoplastic ABS  
UL-94-V0 flame-retardant  
fire-resistant

FINISH Powder Coated White

POWER SUPPLY Factory wired electronic LED driver

## APPLICATION CONDITION

AMBIENT TEMPERATURE RANGE 0 °C to 40°C

## COMPATIBLE MOUNTING

MOUNTING Wall  
Ceiling

## WARRANTY

SYSTEM WARRANTY 2 years

RECOMMENDED BATTERY REPLACEMENT 2 years

## APPROVALS

Certification **UL-924**  
**NFPA 101 Life Safety Code**  
**NEC**  
**OSHA**  
**CEC Title 20 Compliant**

# EXITA SERIES

EMERGENCY LIGHTING

EXITA CR-7082RX

DATE	
PROJECT NAME	
<b>TYPE</b>	
QTY	
ORDERING CODE	<b>CR-7082RX</b>

## PRODUCT DIMENSIONS

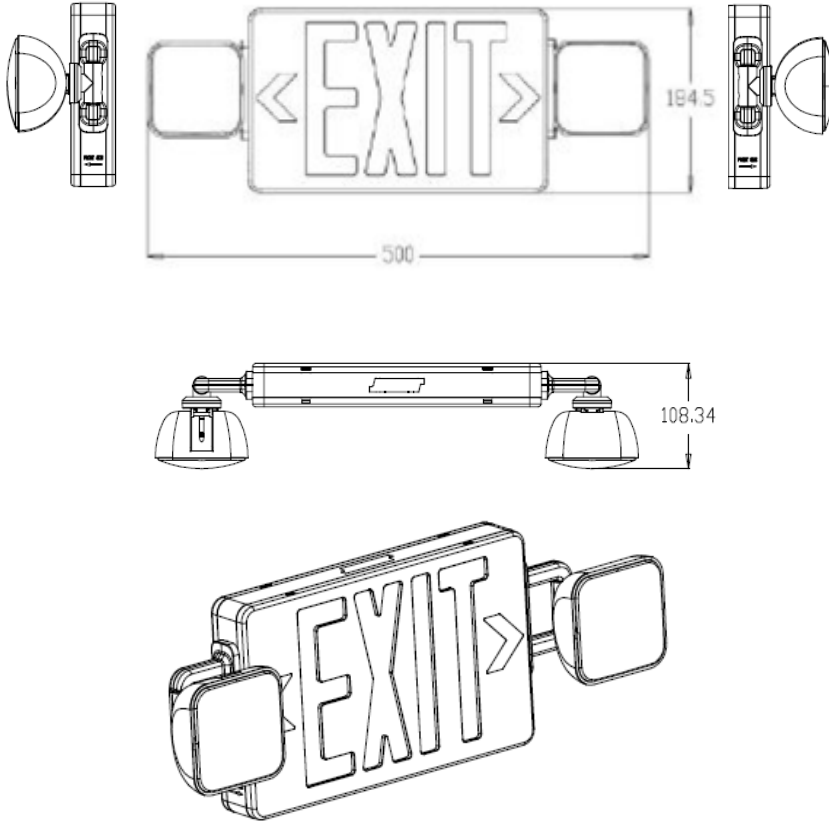

## ORDERING CODE

FIXTURE FAMILY
CR-7082RX
CR-7082RX ERALUX EMERGENCY EXIT SIGN, RED COLORED LETTERS

# EXITA SERIES

EMERGENCY LIGHTING

EXITA CR-7082RX

DATE	
PROJECT NAME	
<b>TYPE</b>	
QTY	
ORDERING CODE	<b>CR-7082RX</b>

## OVERVIEW

### MULTIPLE MOUNTING

It comes with two different mounting types. It can be installed on wall, or on ceiling.

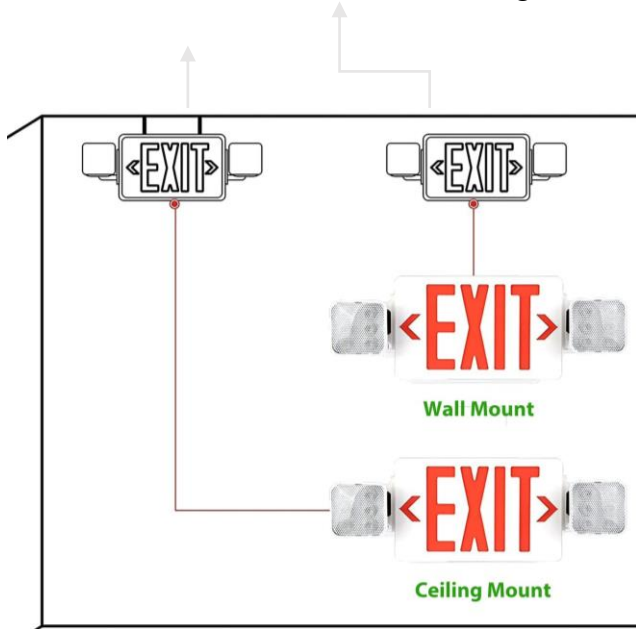

### BATTERY PERFORMANCE

The battery is made of 3.6V NiCad material and it is maintenance free. Its charging time is 24 hours, and it lasts for 90 minutes.

### VALUE ENGINEERED DESIGN

The housing is made of injection-molded thermoplastic ABS to provide safety against flame and fire.

## CONFIGURATIONS

Universal field-selectable single/double-face, with fully illuminated 6" characters using long-life, high intensity LEDs.

## ADJUSTABLE LAMP HEAD

Each lamp head is fully adjustable they can rotate in the three planes as shown on the image. Each head contains 6PCS 0.2W to provide total 2.4W.

