

THALASSA ET6022

OUTDOOR PRODUCTS

Sconce

The Thalassa outdoor cylindrical LED fixture was created with a sleek design deliberately, so it could blend in with many different outdoor building styles. The Thalassa can be mounted to offer either uplight only or downlight only and offers an elegant look in the install environment. Finally, this product is a complete aluminum die cast offering an unparalleled sense of finesse, fixture strength and quality.



eralux®



DATE	
PROJECT NAME	
TYPE	
QTY	
ORDERING CODE	ET6022 - - - -80 - -DMG

OPERATING & ELECTRICAL

INPUT VOLTAGE	120-277Vac
POWER FACTOR	0.9
DIMMING	0-10V external dimming down to 10% (with DMG option)
TOTAL HARMONIC DISTORTION (THD)	<20%

PERFORMANCE

LUMENS PER WATT	~70 LPW at 80CRI
POWER CONSUMPTION	24W
BEAM ANGLE	24W: 10, 25, 38, 45, 60° 40W: 8, 18, 36, 62°

WARRANTY

SYSTEM WARRANTY – 5 YEARS

Eralux will warrant defective drivers, LEDs and boards for 5 years from the date of purchase. This warranty is valid only if the fixture is installed and used as per installation guides and specifications. If a defect is present, Eralux will send drivers and boards at no fee with a thorough replacement instructions along with instructions on the return of the defective parts back to Eralux.

LUMEN MAINTENANCE – L85 at 50,000 hours

Rated for 85% initial lumen output at 50,000 hours of operation, operated at 25°C ambient temperature; per guidelines published by the Illuminating Engineering Society (IES). (L85 at 50,000 hours)

APPLICATION CONDITION

AMBIENT TEMPERATURE RANGE	-25 to 50°C
PROTECTION	IP65

COMPATIBLE MOUNTING

MOUNTING	Wall mount
----------	------------

MECHANICAL & HOUSING

HOUSING	Aluminum die cast
LENS	Highly durable, shatterproof tempered glass lens ensures high efficiency light output for a clean, evenly illuminated surface with minimal glare.
FINISH	ERALUX white, black, gray (RAL9006) powder coat finish
POWER SUPPLY	Factory wired electronic LED driver
LED BOARD	COB

THALASSA ET6022

OUTDOOR PRODUCTS

Sconce

DATE							
PROJECT NAME							
TYPE							
QTY							
ORDERING CODE	ET6022	-	-	-	-80	-	-DMG

ORDERING GUIDE

EXAMPLE: ET6022D-C24-3-25-80-B-DMG

FIXTURE FAMILY	LIGHT DIRECTION	POWER	CCT	BEAM ANGLE	CRI	FINISH	CONTROLS
ET6022		-C24	-	-	-80	-	-DMG
ET6022 ERALUX Thalassa ET6022 outdoor sconce fixture	D Down light	-C24 24 watts: 1680 lumens	-3 3000K CCT	-10 10° beam angle	-80 80 CRI	-B Black powder coat finish	-DMG 0-10V external dimming down to 10%
				-25 25° beam angle			
			U Up light	-4 4000K CCT		-38 38° beam angle	
	-45 45° beam angle						
	-6 6000K CCT			-60 60° beam angle		-S Silver (RAL9006) powder coat finish	

ORDERING GUIDE

EXAMPLE: ET6022D-C40-3-62-80-B-DMG

FIXTURE FAMILY	LIGHT DIRECTION	POWER	CCT	BEAM ANGLE	CRI	FINISH	CONTROLS
ET6022		-C40	-	-	-80	-	-DMG
ET6022 ERALUX Thalassa ET6022 outdoor sconce fixture	D Down light	-C40 40 watts: 2800 lumens	-3 3000K CCT	-08 8° beam angle	-80 80 CRI	-B Black powder coat finish	-DMG 0-10V external dimming down to 10%
				-18 18° beam angle			
	U Up light		-4 4000K CCT	-36 36° beam angle		-W White powder coat finish	
				-5 5000K CCT			

DATE						
PROJECT NAME						
TYPE						
QTY						
ORDERING CODE	ET6022	-	-	-	-80	-DMG

DIMENSIONS

EXAMPLE: ET6022D

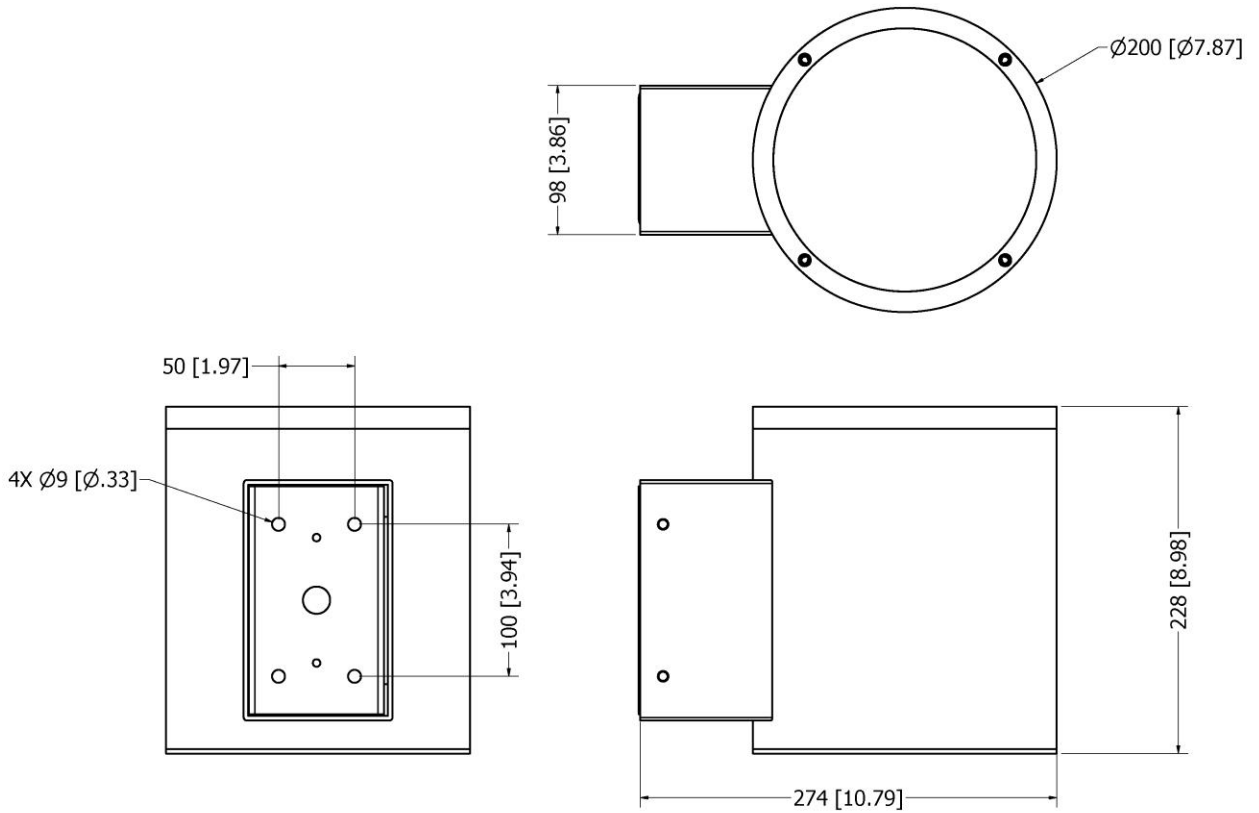

DATE						
PROJECT NAME						
TYPE						
QTY						
ORDERING CODE	ET6022	-	-	-	-80	-DMG

LUMEN ESTIMATE

Lumen output varies based on CCT and CRI. An estimate of lumen output of the various CCT/CRI combinations, use correction factors as per table below:

LUMEN ESTIMATE ADJUSTMENT FACTORS				
CCT	2700K	3000K	3500K	4000K
NORMAL (80CRI)	0.94	1	1.02	1.03

PHOTOMETRIC DATA

GRID DISTANCES WITH A MOUNTING HEIGHT OF 10' AFG

POLAR LUMINOUS INTENSITY GRAPHS

ET6022D-C24-3-25-80

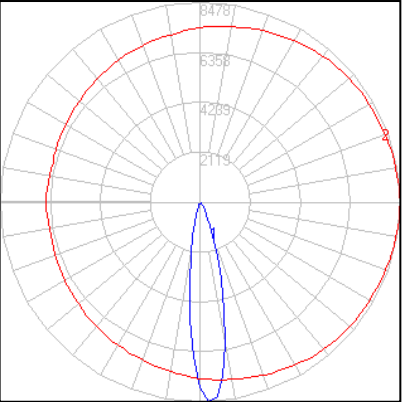
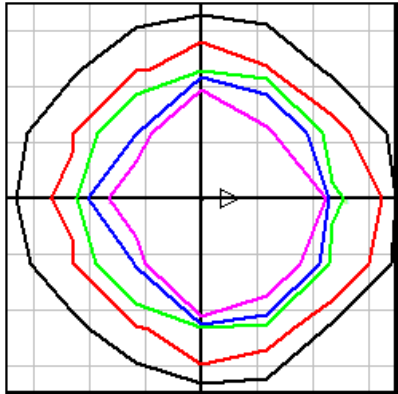

ET6022D-C24-3-60-80

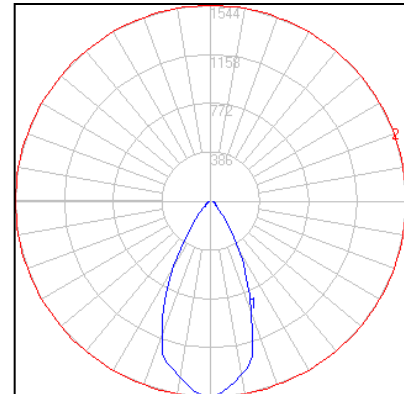
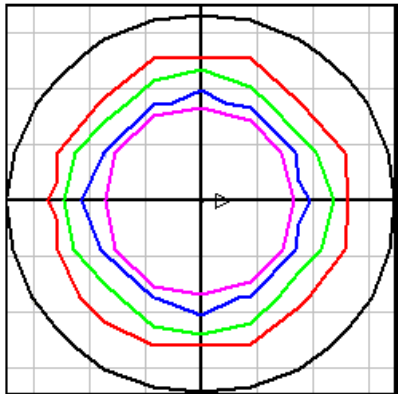

DATE						
PROJECT NAME						
TYPE						
QTY						
ORDERING CODE	ET6022	-	-	-	-80	-DMG

ACCESSORIES

Ordered separately, field installed

EMERGENCY LED DRIVER (BLD-CM20N-480800-8W)

BLD-CM20N-480800-8W

OUTPUT POWER : 8 WATTS



- Easy Wiring
- Certified For CA Title 20
- Constant Power Performance

BLD-CM20N-480800-8W LED Emergency Driver is UL listed for field and factory installation that allows the same LED fixture to be used for both normal and emergency operation. In the event of a power failure, the emergency driver switches to emergency mode and operates the fixture for 90 minutes. The unit contains a battery, charge, and converter circuit in a single enclosure. This module will operate a LED array load at 8W with constant power at a rated output voltage of 25-48 VDC. The constant power design of BLD-CM20N-480800-8W maintains the output wattage to the LED array, providing consistent illumination for the entire emergency runtime. Its slim shape is ideal for use indoor or outdoor LED lighting fixtures, such as linear lights, wall packs or sconces, etc.

DIMENSIONS (inches and mm)

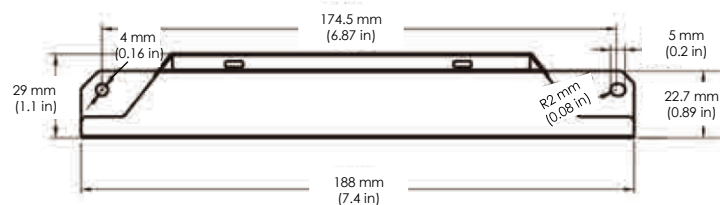
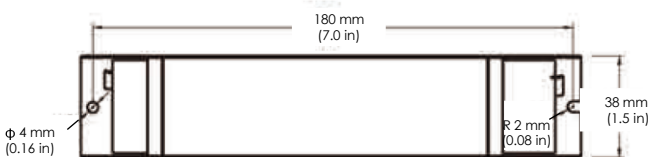

DATE						
PROJECT NAME						
TYPE						
QTY						
ORDERING CODE	ET6022	-	-	-	-80	-DMG

OVERVIEW



PREMIUM MATERIALS

Constructed from aluminum die-cast enhancing thermal heat dissipation while providing excellent figure strength.

MULTIPLE BEAM ANGLES

Customize your fixture with a unique set of beam angles in the up light or downlight orientation with the option to having a 20-degree tilt towards the wall.

MULTIPLE FINISH OPTIONS

Select from black, white, or silver powder coat anti-cracking finishes to accent your project space

CRI

80 CRI provides greater rendering allowing for a more natural light look

