

TITAN ELITE – TT2



INDUSTRIAL LED LIGHT

Linear High Bay | Adjustable Tilt | 225W - 300W

The TITAN ELITE series offers an impressive range of features, including switchable power options of 225/165/120 Watts or 300/225/165 Watts, and an efficiency of 135 LPW. This series includes a switchable lumens package, customizable correlated color temperature (CCT), and a tiltable light engine. The tiltable light engine can be rotated on-site; 20° inwards and 80° outwards, allowing for tailored light distributions that meet the specific needs of any project space.

Application: Industrial, Manufacturing, Warehouse, High-bay applications.

	DATE	QTY	ACC. QTY	TYPE
PROJECT				
PN				
ACCESSORY PN				
NOTES				



DYNAMIC MENU

Order Information	Page 2
Dimensions	Page 3
Accessories	Page 3
Photometric Data	Page 7

[Install Instruction link](#)

SPECIFICATIONS

Input Voltage	120-347V
Power Factor	>0.9
Total Harmonic Distortion	<20%
Dimming	0-10V Dimming
CRI	80 CRI
CCT	<div style="display: flex; gap: 10px;"> <div style="border: 1px solid gray; border-radius: 50%; padding: 2px 5px;">35K</div> <div style="border: 1px solid gray; border-radius: 50%; padding: 2px 5px;">40K</div> <div style="border: 1px solid gray; border-radius: 50%; padding: 2px 5px;">50K</div> </div>
Lumens Per Watt	~135 LPW
Power	120/165/225W 165/225/300W
Ambient Temperature Range	-40 °C to 45 °C
Distribution	90° Beam Angle
Tilt	80° outward 20° inward
Mounting Options	Suspended Pendant Surface



PRODUCT FEATURES

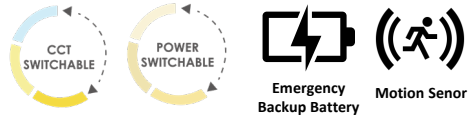

PRODUCT CERTIFICATIONS



“Design Lights Consortium® (DLC) qualified product. Not all versions of this product may be DLC qualified. Please check the DLC Qualified Products List at www.designlights.org/QPL to confirm which versions are qualified” [Page 8](#)

SYSTEM WARRANTY – 5 YEARS

Eralux will warrant defective drivers, LEDs and boards for 5 years from the date of purchase. This warranty is valid only if the fixture is installed and used as per installation guides and specifications. If a defect is present, Eralux will send drivers and boards at no fee with a thorough replacement instructions along with instructions on the return of the defective parts back to Eralux.

LUMEN MAINTENANCE – L70 at 50,000 hours

Rated for 70% initial lumen output at 50,000 hours of operation, operated at 25°C ambient temperature; per guidelines published by the Illuminating Engineering Society (IES).

TITAN ELITE – TT2

INDUSTRIAL LED LIGHT

Linear High Bay | Adjustable Tilt | 225W - 300W

ORDERING GUIDE

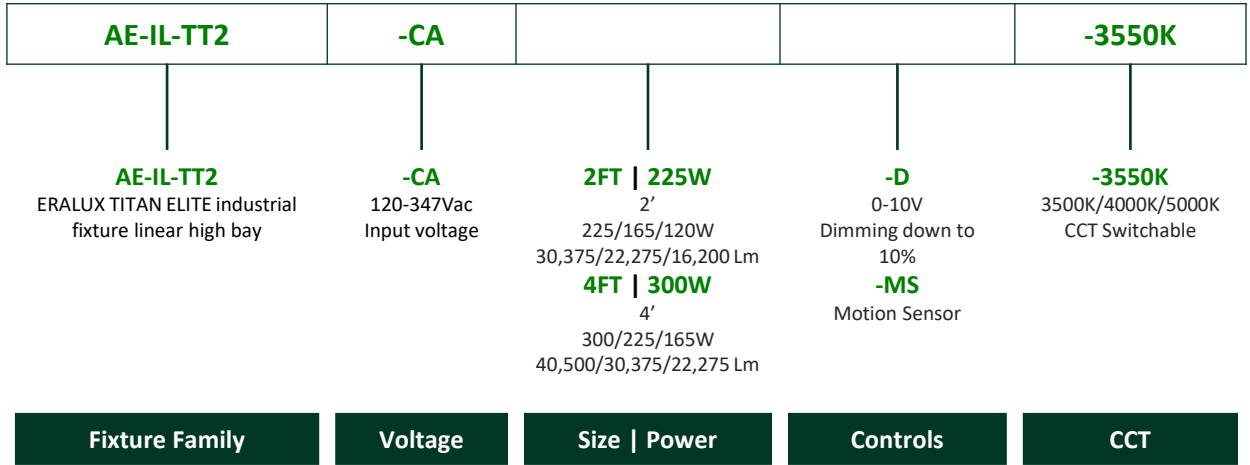

The fixture comes with chains.

ORDERING GUIDE - ACCESSORIES

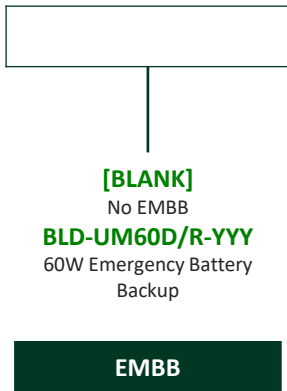
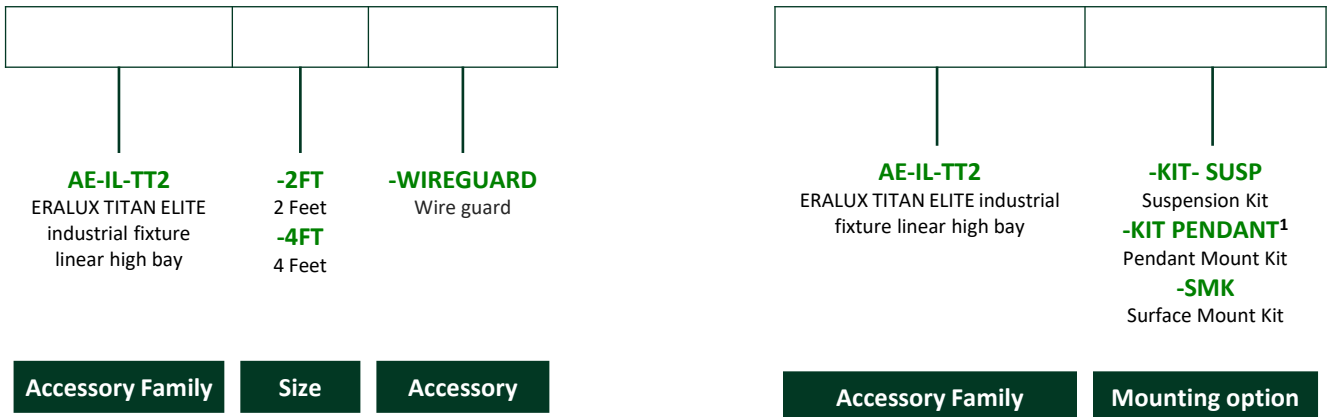

1. Conduit supplied by others

TITAN ELITE – TT2

INDUSTRIAL LED LIGHT

Linear High Bay | Adjustable Tilt | 225W - 300W

DIMENSIONS

FIXTURE

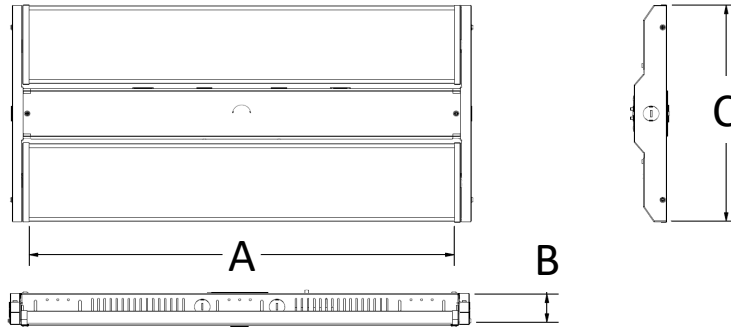

SIZE	2FT	4FT
A	25.75"	47"
B	2"	2"
C	12.82"	12.82"

ACCESSORIES

PART NUMBER	DESCRIPTION	PICTURE
AE-IL-TT2-2FT-WIREGUARD AE-IL-TT2-4FT-WIREGUARD	2FT/4FT Wire Guard (1 piece)	
AE-IL-TT2-10FT-CHAINS	Suspension Kit: Chains come with fixture	
AE-IL-TT2-KIT-PENDANT	Pendant Mount Kit: Bucket for mounting conduit (conduit supplied by others)	
AE-IL-TT2-SMK	Surface Mount Kit: Brackets (2 pieces)	

TITAN ELITE – TT2

INDUSTRIAL LED LIGHT

Linear High Bay | Adjustable Tilt | 225W - 300W

DLC MODELS



DLC MODEL	PRODUCT ID
AE-IL-TT2CA2FT225W-XX-3550K	S-316FY9
AE-IL-TT2CA4FT300W-XX-3550K	S-2Z43CR

DIMMER COMPATIBILITY LIST

ELV Dimming

Brand	Model	Brand	Model
Lutron	DVSTV	Legrand	WS4FBL3PTC
	LNTSTV-DV		RH4FBL3PTC
Leviton	AWSMT-7DW	Cooper	SF10P
	DD710-BDZ	Hubble	LHD-IRS3-N-WH
	DS710-10Z		

CONTROLS

EMERGENCY LED DRIVER

Ordered separately, field installed

BLD-UM60D/R-YYY



The BLD-UMXXX-YYY series LED Emergency Driver is UL listed for field and factory installation, allowing a single LED fixture to operate in both normal and emergency modes. In case of power failure, it powers the fixture for up to 90 minutes, integrating a battery, charger, and converter in one unit. Supporting LED loads of 30-60W at 170VDC, its constant power design ensures consistent illumination during emergencies, making it ideal for 0-10V dimmable indoor industrial LED fixtures, such as flat panels, troffers, and UFO lights.

SPECIFICATIONS	
Input Voltage	100-347 Vac
Power Frequency	50/60HZ
Input Power	15W MAX
Output Voltage	170V Dc
Output Power	60W
Ambient Temperature	5°C to 50°C
	41°F to 122°F
Installation	Remote

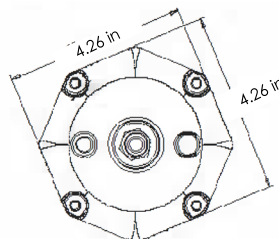
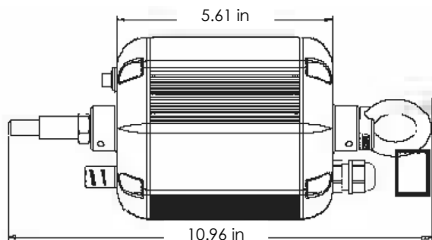

Energy savings breakdown for traditional lamp to led conversion ERALUX



HID 400W

System Power	460W
--------------	------

**74%
Energy Savings**



TT2	2FT
Power	120W
Lumens	16,200



6L T5HO

System Power	350W
--------------	------

**53%
Energy Savings**



TT2	2FT
Power	165W
Lumens	22,275



HID 750W

System Power	840W
--------------	------

**73%
Energy Savings**



TT2	2FT
Power	225W
Lumens	30,375



HID 850W

System Power	955W
--------------	------

**70%
Energy Savings**



TT2	4FT
Power	300W
Lumens	40,500

CONTROLS

MOTION SENSOR

CODE	DESCRIPTION	PICTURE
AE-IL-SB2-CA-MSKIT	Plug in low-voltage microwave motion sensor	
AE-IL-SB2-CA-REMOTE-CTRL	Remote control for the motion sensor	

Factory mode

Factory Default Setting	
Sensitivity	100%
Hold on time	5 min
Daylight Sensor	ON
Dimming level	30%
Dimming time	30 min

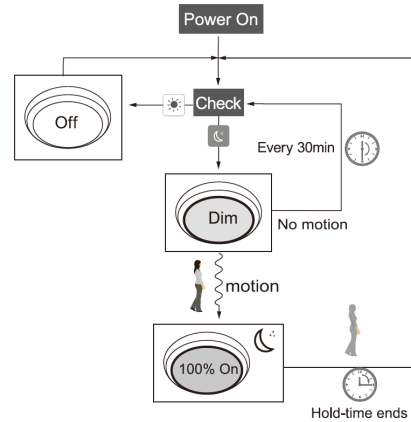

Area Coverage

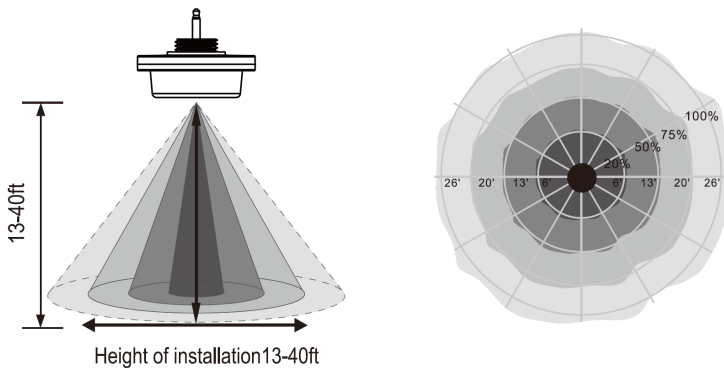

INDUSTRIAL LED LIGHT

Linear High Bay | Adjustable Tilt | 225W - 300W

LUMEN ESTIMATE

Lumen output varies based on CCT and CRI. An estimate of lumen output of the various CCT/CRI combinations, use correction factors as per table below:

LUMEN ESTIMATE ADJUSTMENT FACTORS			
CCT	3500K	4000K	5000K
PREMIUM (80CRI)	0.97	1	1.03

PHOTOMETRIC DATA

PART NUMBER		ZONAL LUMEN SUMMARY			POLAR LUMINOUS INTENSITY	CONE DISTRIBUTION			
AE-IL-TT2-CA-2FT-225W-XX-XX		Zone	Lumens	% Fixture	Direct Light	Center Beam Fc	Beam Width		
Wattage	225W	0-20°	5075.93	16.9		1.7ft	6418 fc	3.5 ft	3.2 ft
CCT	3500K	0-30°	10784.64	35.8		3.3ft	1703 fc	6.9 ft	6.2 ft
Distribution	90°	0-40°	17389.44	57.7		5.0ft	742 fc	10.4 ft	9.4 ft
		0-60°	25849.45	85.8		6.7ft	413 fc	13.9 ft	12.5 ft
		0-80°	29250.96	97.1		8.3ft	269 fc	17.3 ft	15.5 ft
		0-90°	29734.29	98.7		10.0ft	185 fc	20.8 ft	18.7 ft
						■ Vert. Spread: 92.3° ■ Horiz. Spread: 86.2°			

PART NUMBER		ZONAL LUMEN SUMMARY			POLAR LUMINOUS INTENSITY	CONE DISTRIBUTION			
AE-IL-TT2-CA-2FT-165W-XX-XX		Zone	Lumens	% Fixture	Direct Light	Center Beam Fc	Beam Width		
Wattage	165W	0-20°	3722.24	16.9		1.7ft	4814 fc	3.5 ft	3.2 ft
CCT	3500K	0-30°	7908.51	35.8		3.3ft	1277 fc	6.9 ft	6.2 ft
Distribution	90°	0-40°	12751.9	57.7		5.0ft	556 fc	10.4 ft	9.4 ft
		0-60°	18955.73	85.8		6.7ft	310 fc	13.9 ft	12.5 ft
		0-80°	21450.09	97.1		8.3ft	202 fc	17.3 ft	15.5 ft
		0-90°	21804.53	98.7		10.0ft	139 fc	20.8 ft	18.7 ft
						■ Vert. Spread: 92.3° ■ Horiz. Spread: 86.2°			

PART NUMBER		ZONAL LUMEN SUMMARY			POLAR LUMINOUS INTENSITY	CONE DISTRIBUTION			
AE-IL-TT2-CA-2FT-300W-XX-XX		Zone	Lumens	% Fixture	Direct Light	Center Beam Fc	Beam Width		
Wattage	300W	0-20°	6768.03	16.9		1.7ft	4814 fc	3.5 ft	3.2 ft
CCT	3500K	0-30°	14379.78	35.8		3.3ft	1277 fc	6.9 ft	6.2 ft
Distribution	90°	0-40°	23186.34	57.7		5.0ft	556 fc	10.4 ft	9.4 ft
		0-60°	34466.56	85.8		6.7ft	310 fc	13.9 ft	12.5 ft
		0-80°	39001.98	97.1		8.3ft	202 fc	17.3 ft	15.5 ft
		0-90°	39646.44	98.7		10.0ft	139 fc	20.8 ft	18.7 ft
						■ Vert. Spread: 92.3° ■ Horiz. Spread: 86.2°			

PART NUMBER		ZONAL LUMEN SUMMARY			POLAR LUMINOUS INTENSITY	CONE DISTRIBUTION			
AE-IL-TT2-CA-4FT-225W-XX-XX		Zone	Lumens	% Fixture	Direct Light	Center Beam Fc	Beam Width		
Wattage	225W	0-20°	5075.97	16.9		1.7ft	3530 fc	3.5 ft	3.2 ft
CCT	3500K	0-30°	10784.72	35.8		3.3ft	937 fc	6.9 ft	6.2 ft
Distribution	90°	0-40°	17389.57	57.7		5.0ft	408 fc	10.4 ft	9.4 ft
		0-60°	25849.64	85.8		6.7ft	227 fc	13.9 ft	12.5 ft
		0-80°	29251.17	97.1		8.3ft	148 fc	17.3 ft	15.5 ft
		0-90°	29734.51	98.7		10.0ft	102 fc	20.8 ft	18.7 ft
						■ Vert. Spread: 92.3° ■ Horiz. Spread: 86.2°			

OVERVIEW



Innovative Design

- Aluminum die-cast and heat sink to ensure superior thermal heat dissipation.



Multiple Options

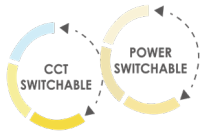

- 2 sizes 225W-300W.
- Power switchable.
- 3 CCT selectable; 35/40/50K

SIZE	POWER	LUMENS
225W	225/165/120W	30,375/22,275/16,200 Lm
300W	300/225/165W	40,500/30,375/22,275 Lm



FEATURE

- Equipped with a tiltable lens that can be rotated 20°inwards and 80°outwards perfect for tennis courts



Mountings Available

- Suspended (Chains)
- Pendant Mount.
- Surface Mount



ACCESSORIES

- Wire guard.
- EMBB.
- Motion Sensor



Emergency backup battery



Motion Sensor



Tests And Certifications

