

ELEGANZA

CYLINDER LIGHTING

Indoor Pendant



eralux®



The **ELEGANZA** Pendant series is a beautiful and elegant solution for open ceilings, and it has a distinctive design featuring machined aluminum body, attention to details including the installation process. The ELEGANZA also has an impressive LPW providing performance as well as elegance in the install environment. Finally, this product is a complete aluminum die cast offering an unparalleled sense of finesse, robustness and quality. It comes in various mounting options such as wall mount, surface mount, pendant and cord stem mount.

DATE	
PROJECT NAME	
TYPE	
QTY	
NOTES	

OPERATING & ELECTRICAL

INPUT VOLTAGE	120-277V
POWER FACTOR	0.9
DIMMING	Tri-Mode Dimming™(TRIAC, ELV & 0-10 V)
TOTAL HARMONIC DISTORTION (THD)	<20%

PERFORMANCE

LUMENS PER WATT	95 LPW at 90CRI
POWER CONSUMPTION	Up to 20W(Surface) Up to 28W (Suspended)
BEAM ANGLE	15°, 30°, 40°, 55°

MECHANICAL & HOUSING

HOUSING	Aluminum die cast
LENS	Highly durable polycarbonate lens
FINISH	White, black, silver
POWER SUPPLY	Factory wired electronic LED driver
LED BOARD	COB

APPLICATION CONDITION

AMBIENT TEMPERATURE RANGE	10 °C to 35°C
---------------------------	---------------

COMPATIBLE MOUNTING

MOUNTING	Wall, stem, cable, surface mounted
----------	------------------------------------

WARRANTY

SYSTEM WARRANTY – 5 YEARS

Eralux will warrant defective drivers, LEDs and boards for 5 years from the date of purchase. This warranty is valid only if the fixture is installed and used as per installation guides and specifications. If a defect is present, Eralux will send drivers and boards at no fee with a thorough replacement instructions along with instructions on the return of the defective parts back to Eralux.

LUMEN MAINTENANCE – L85 at 50,000 hours

Rated for 85% initial lumen output at 50,000 hours of operation, operated at 25°C ambient temperature; per guidelines published by the Illuminating Engineering Society (IES). (L85 at 50,000 hours)

ELEGANZA

CYLINDER LIGHTING

Indoor Pendant

DATE	
PROJECT NAME	
TYPE	
QTY	
NOTES	

ORDERING GUIDE

EXAMPLE: AE-TL-EZ-40R12-SF-00-20-C3030-P-T-WH

FIXTURE FAMILY	PRODUCT CODE	HEIGHT	MOUNTING METHOD	POWER	CCT	BEAM ANGLE	CRI	FINISH	
AE-TL-EZ	-40R	12	-SF-00	-20	-C		-P-T	-	
AE-TL-EZ ERALUX Eleganza indoor cylindrical pendant fixture	-40R	12 12" fixture height	-SF-00 Surface mounted fixture mounting method	-20 20 watts: 1,900 lumens at 90CRI 3000K	-C27 2700K CCT	15° 15° beam angle	-P-T Premium 90 CRI	-WH White powder coat finish RAL9003	
					-C30 3000K CCT	30° 30° beam angle			-BK Black powder coat finish RAL9004
					-C35 3500K CCT	40° 40° beam angle			-SV Silver powder coat finish RAL9006
					-C40 4000K CCT	55° 55° beam angle			-RALXXXX Customed finish

* Custom color finish available.
Please contact us for more information and pricing

FIXTURE FAMILY	PRODUCT CODE	HEIGHT	MOUNTING METHOD	POWER	CCT	BEAM ANGLE	CRI	FINISH	
AE-TL-EZ	-40R	12	-WM-00	-	-C		-P-T	-	
AE-TL-EZ ERALUX Eleganza indoor cylindrical pendant fixture	-40R	12 12" fixture height	-WM-00 Wall mount fixture mounting method	-20 20 watts: 1900 lumens at 90CRI 3000K	-C27 2700K CCT	15° 15° beam angle	-P-T Premium 90 CRI	-WH White powder coat finish RAL9003	
					-C30 3000K CCT	30° 30° beam angle			-BK Black powder coat finish RAL9004
					-C35 3500K CCT	40° 40° beam angle			-SV Silver powder coat finish RAL9006
					-C40 4000K CCT	55° 55° beam angle			-RALXXXX Customed finish

DATE	
PROJECT NAME	
TYPE	
QTY	
NOTES	

ORDERING CODE

FIXTURE FAMILY	PRODUCT CODE	HEIGHT	MOUNTING METHOD	CABLE LENGTH	POWER	CCT	BEAM ANGLE	CRI	FINISH	
AE-TL-EZ	-40R	12	-PC		-	-C		-P-T	-	
AE-TL-EZ ERALUX Eleganza indoor cylindrical pendant fixture	-40R	12 12" fixture height	-PC Pendant Cord fixture mounting method	-03 3' cable	-20 20 watts: 1900 lumens at 90CRI 3000K	-C27 2700K CCT	15 15° beam angle	-P-T Premium 90 CRI	-WH White powder coat finish RAL9003	
				-06 6' cable		-C30 3000K CCT				30 30° beam angle
				-09 9' cable	-28 28 watts: 2400 lumens at 90CRI 3000K	-C35 3500K CCT	40 40° beam angle			
				-12 12' cable		-C40 4000K CCT	55 55° beam angle			-BK Black powder coat finish RAL9004
									-SV Silver powder coat finish RAL9006	
										-RALXXXX Customed finish

FIXTURE FAMILY	PRODUCT CODE	HEIGHT	MOUNTING METHOD	STEM LENGTH	POWER	CCT	BEAM ANGLE	CRI	FINISH	
AE-TL-EZ	-40R	12	-SM		-	-C		-P-T	-	
AE-TL-EZ ERALUX Eleganza indoor cylindrical pendant fixture	-40R	12 12" fixture height	-SM Stem mount fixture mounting method	-01 1' stem	-20 20 watts: 1900 lumens at 90CRI 3000K	-C27 2700K CCT	15 15° beam angle	-P-T Premium 90 CRI	-WH White powder coat finish RAL9003	
				-02 2' stem		-C30 3000K CCT				30 30° beam angle
				-03 3' stem	-28 28 watts: 2400 lumens at 90CRI 3000K	-C35 3500K CCT	40 40° beam angle			
				-04 4' stem		-C40 4000K CCT	55 55° beam angle			-BK Black powder coat finish RAL9004
									-SV Silver powder coat finish RAL9006	
										-RALXXXX Customed finish

DATE	
PROJECT NAME	
TYPE	
QTY	
NOTES	

CUSTOMED FINISH EXAMPLES FOR ELEGANZA SERIES

* Please contact manufacturer for more information and pricing for customized finishes

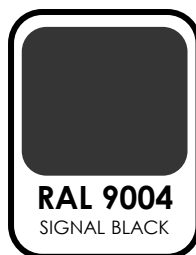
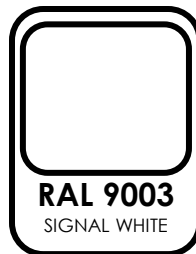
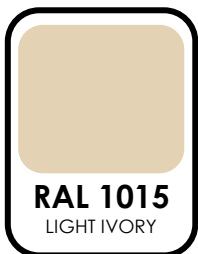
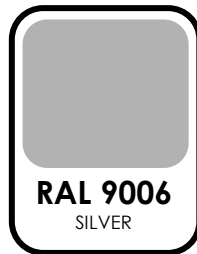
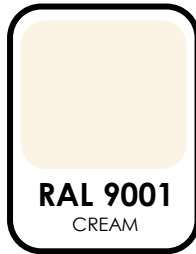

DATE	
PROJECT NAME	
TYPE	
QTY	
NOTES	

DIMENSIONS

EXAMPLE: AE-TL-EZ-40R12-SF-00-20-CXX30-P-T-XX

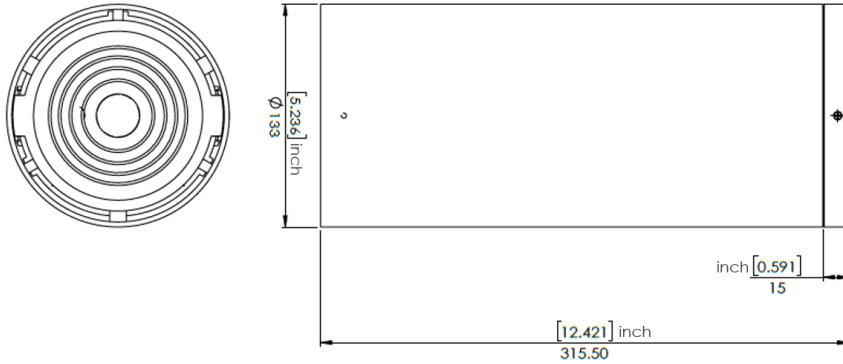

EXAMPLE: AE-TL-EZ-40R12-SM-XX-20-CXX30-P-T-XX

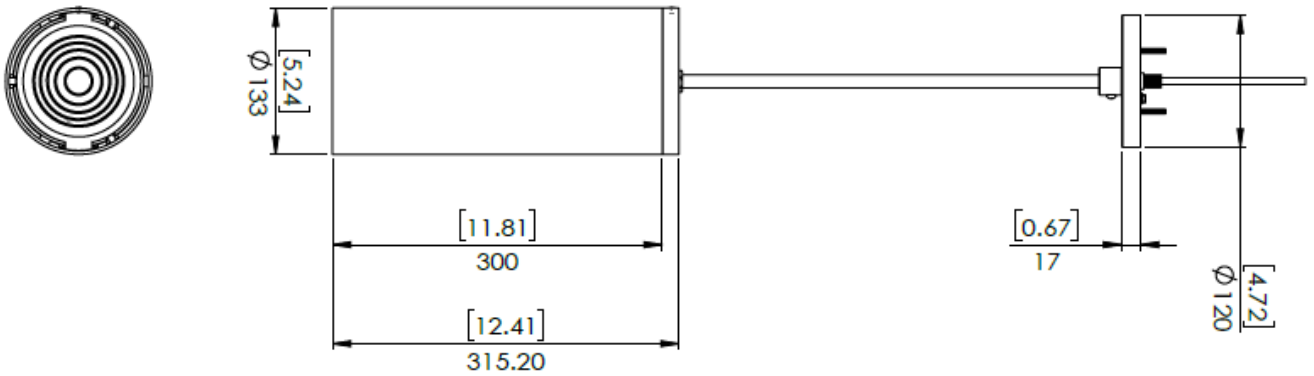

EXAMPLE: AE-TL-EZ-40R12-PC-XX-20-CXX30-P-T-XX

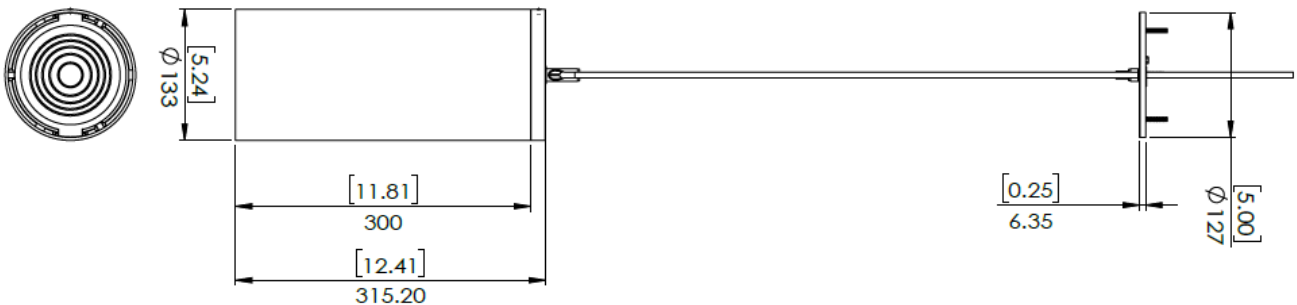

DATE	
PROJECT NAME	
TYPE	
QTY	
NOTES	

DIMENSIONS

EXAMPLE: AE-TL-EZ-40R12-SF-00-20-CXX30-P-T-XX

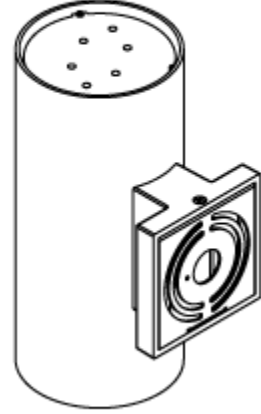
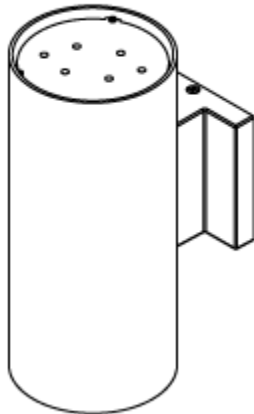
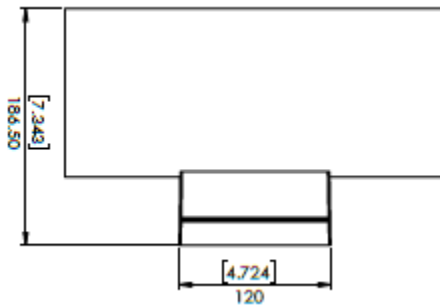
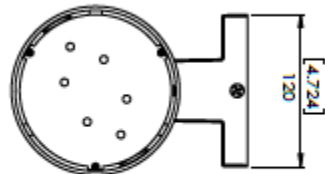
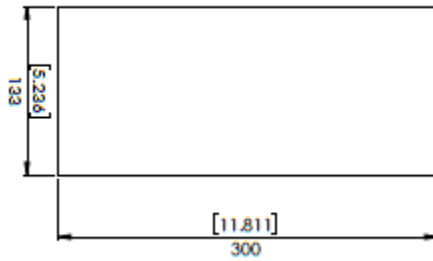

DATE	
PROJECT NAME	
TYPE	
QTY	
NOTES	

LUMEN ESTIMATE

Lumen output varies based on CCT and CRI. An estimate of lumen output of the various CCT/CRI combinations, use correction factors as per table below:

LUMEN ESTIMATE ADJUSTMENT FACTORS				
CCT	2700K	3000K	3500K	4000K
NORMAL (80CRI)	0.93	1	1.07	1.07
PREMIUM (90CRI)	0.8	0.86	0.93	0.93

PHOTOMETRIC DATA

AE-TL-EZ-40R12-SF-00-20-C3030-P-T-XX

GRID DISTANCES WITH A MOUNTING HEIGHT OF 10' AFG

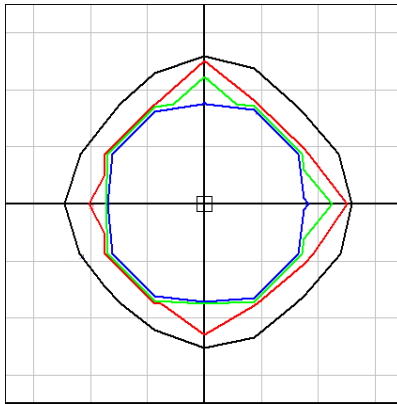

POLAR LUMINOUS INTENSITY GRAPHS

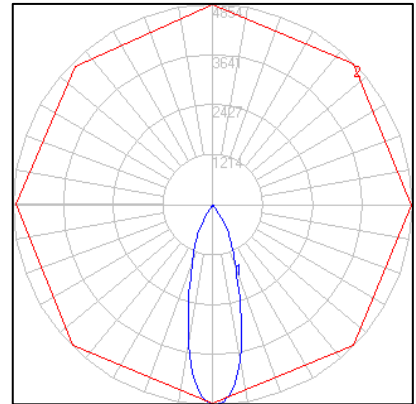

AE-TL-EZ-40R12PC-X-28-C4030-P-T-XX

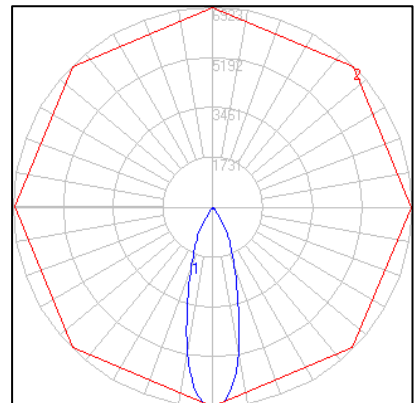
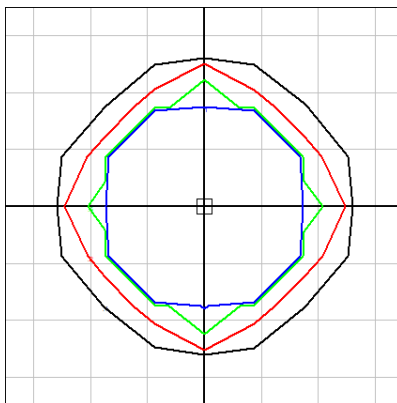

DATE	
PROJECT NAME	
TYPE	
QTY	
NOTES	

DIMMER COMPATIBILITY LIST (SF, PC & WM)

TRIAC/ELV Dimmer @120VAC
Lutron S-603PG
Lutron DVELV-303P
Lutron CT-103P
Leviton IPI06-1LZ
Lutron SELV-300P
Cooper SLC03P
Leviton 6631-2
Leviton 6683-IW
Leviton IPE04
Lutron DVCL-153P
Leviton 6161
Lutron MAELV-600
Lutron DVLV-600P

TRIAC/ELV Dimmer @120VAC
Leviton 6633-P
Lutron FAELV-500
Lutron TGCL-153P
Lutron TG-600P
Lightolier ZP260QEW
Lutron S-600P
Cooper DLC03P
Cooper DAL06P
Leviton VPE06
Lutron LG-600P

0-10V Dimmer@120VAC
Lutron, Nova series (part number NFTV)
Lutron, Diva series (part number DVTV)
Leviton, IllumaTech series (part number IP710-DL)

ELEGANZA

CYLINDER LIGHTING

Indoor Pendant

DATE	
PROJECT NAME	
TYPE	
QTY	
NOTES	

OVERVIEW



MULTIPLE MOUNTING METHODS

Select from multiple mounting styles including surface, wall, cable, and stem mount.



Wall mount



Stem mount



Cable mount

COLOR OPTIONS

Select from standard white, black, and silver or inquire about a custom finish unique for your project.



UNIQUE FIXTURE

The Eleganza features several beam angles including 15, 30, 40 and 55 degrees.

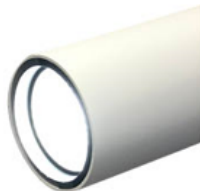

PREMIUM MATERIALS

Constructed from aluminum diecast for excellent fixture structure strength, and for superior thermal heat management, all ensuring long-lasting LED and driver function.

