

G5 Recessed T-grid

LINEAR FIXTURES

Linear Architectural Lighting



The G5 T-Grid series provide an unsurpassed flexibility for commercial offices. With a simple switch, the fixture can switch CCT and lumens. Long seamless rows are possible using custom lengths for starter, middle and ender. It is perfect for new buildings, upgrades and retrofit projects. This series has been redesigned to be easily mounted on most T grids ceilings.

eralux®



DATE						
PROJECT NAME						
TYPE						
QTY						
ORDERING CODE	AE-SF-G5CA				010	-R-

OPERATING & ELECTRICAL

INPUT VOLTAGE	120-347V
POWER FACTOR	0.9
DIMMING	0-10V
TOTAL HARMONIC DISTORTION (THD)	<20%

PERFORMANCE

LUMENS PER WATT	105 LPW at 80CRI
POWER	40W
DISTRIBUTION	Lambertian

MECHANICAL & HOUSING

HOUSING	Extruded aluminum for increased rigidity and strength
LENS	Highly durable frosted polycarbonate and high transmittance lens
FINISH	Nebula White Atomic Black
POWER SUPPLY	Factory wired electronic LED driver
LED BOARD	Discrete LED

APPLICATION CONDITION

AMBIENT TEMPERATURE RANGE	-10°C to 40°C
---------------------------	---------------

COMPATIBLE MOUNTING

MOUNTING	Recessed (Non-IC rated)
----------	-------------------------

WARRANTY

SYSTEM WARRANTY – 5 YEARS

Eralux will warrant defective drivers, LEDs and boards for 5 years from the date of purchase. This warranty is valid only if the fixture is installed and used as per installation guides and specifications. If a defect is present, Eralux will send drivers and boards at no fee with a thorough replacement instructions along with instructions on the return of the defective parts back to Eralux.

LUMEN MAINTENANCE – L85 at 50,000 hours

Rated for 85% initial lumen output at 50,000 hours of operation, operated at 25°C ambient temperature; per guidelines published by the Illuminating Engineering Society (IES).

G5 Recessed T-grid

LINEAR FIXTURES

Linear Architectural Lighting

DATE	
PROJECT NAME	
TYPE	
QTY	
ORDERING CODE	AE-SF-G5CA 010 -R-

ORDERING GUIDE

EXAMPLE: AE-SF-G5CA44030/35/40010WH-R-A-1DIM

FIXTURE FAMILY	VOLTAGE	LENGTH	POWER	CCT	CONTROLS	FINISH	MOUNTING	TYPE	DIMMING
AE-SF-G5	CA				010		-R-		
AE-SF-G5 ERALUX G5 linear architectural fixture	CA 120-347Vac input voltage	2 2 feet	20 20 watts: 2,100 lumens	30/35/40 3000/3500/4000K selectable CCT	010 0-10V external dimming down to 10%	WH-GB ERALUX Nebula White	-R- Recessed mounted on T-grids	A Stand alone	[LEAVE BLANK] 0-10V Standard
		4 4 feet	40 40 watts: 4,200 lumens						
		5 5 feet							
		6 6 feet	50 50 watts: 5,250 lumens						
		8 8 feet	70 70 watts: 8,400 lumens					BK-GB ERALUX Atomic Black finish	
			C Middle						

CAUTION: If there are multiple fixtures connected to the same 0-10V dimming line, a 0-10V controller must be considered to enable consistent dimming across the fixtures. Failure to do so will lead to inconsistent dimming and behaviors in the fixtures. Single switch is not recommended for controlling multiple fixtures simultaneously.

* 1DIM available only in 120-277V, it works for 4,5,6,8 FT

Maximum of 300 Wattages powered by 1 electrical drop

POWER SWITCHABLE OPTIONS

2FT		20 watts	20W – 2100 lms
4/5FT	Avg 105-120 LPW		20W – 2100 lms
		20/30/40 watts switchable	30W - 3150 lms
			40W - 4200 lms
6FT		30/40/50 watts switchable	30W - 3600 lms
			40W - 4800 lms
			50W - 6000 lms
8FT			40W - 4800 lms
		40/70 watts switchable	70W - 8400 lms

G5 Recessed T-grid

LINEAR FIXTURES

Linear Architectural Lighting

DATE	
PROJECT NAME	
TYPE	
QTY	
ORDERING CODE	AE-SF-G5CA 010 -R-

ACCESSORIES (Continued)

Ordered separately, field installed

EMERGENCY LED DRIVER (BLD-YTXXD-XXX)

BLD-YT08D-XXX

OUTPUT POWER : 8 WATTS

BLD-YT15D-XXX

OUTPUT POWER : 15 WATTS



- Easy Wiring
- Certified For CA Title 20
- Constant Power Performance

BLD-YTXXD-XXX LED Emergency Driver is UL listed for field and factory installation that allows the same LED fixture to be used for both normal and emergency operation. In the event of a power failure, the emergency driver switches to emergency mode and operates the fixture for 90 minutes. This module will operate a LED array load at 8W or 15W with constant power at a rated output voltage of 30-60 VDC. The constant power design of BLD-YTXXD-XXX maintains the output wattage to the LED array, providing consistent illumination for the entire emergency runtime. Its slim shape is ideal for use in linear LED lighting fixtures.

DIMENSIONS (inches and mm)

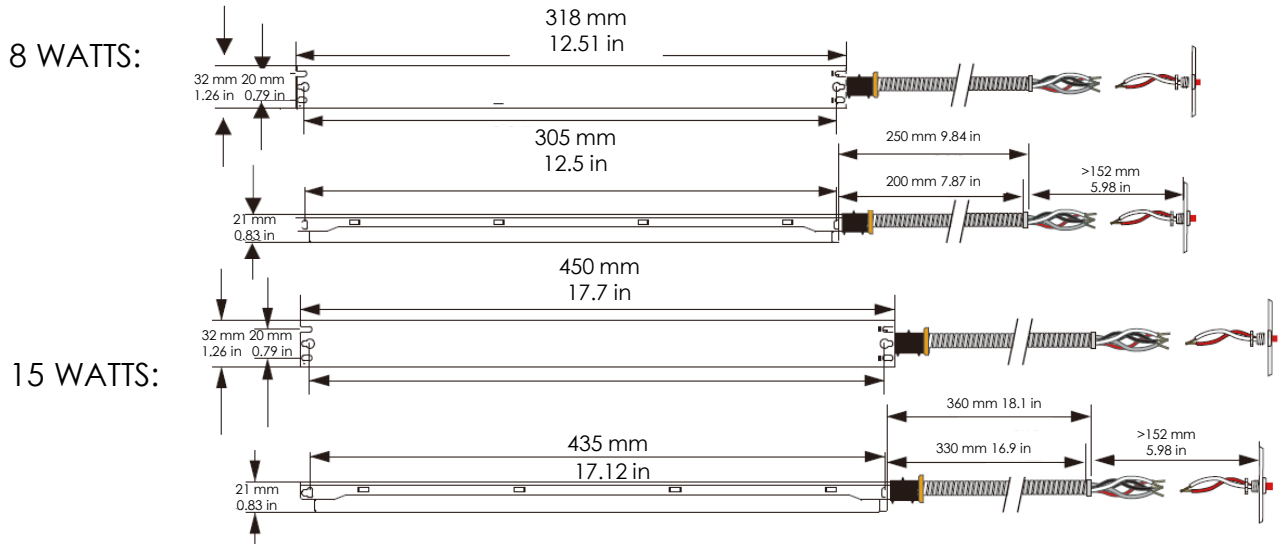

G5 Recessed T-grid

LINEAR FIXTURES

Linear Architectural Lighting

DATE	
PROJECT NAME	
TYPE	
QTY	
ORDERING CODE	AE-SF-G5CA 010 -R-

PRODUCT DIMENSION – 4FT

A – Stand alone

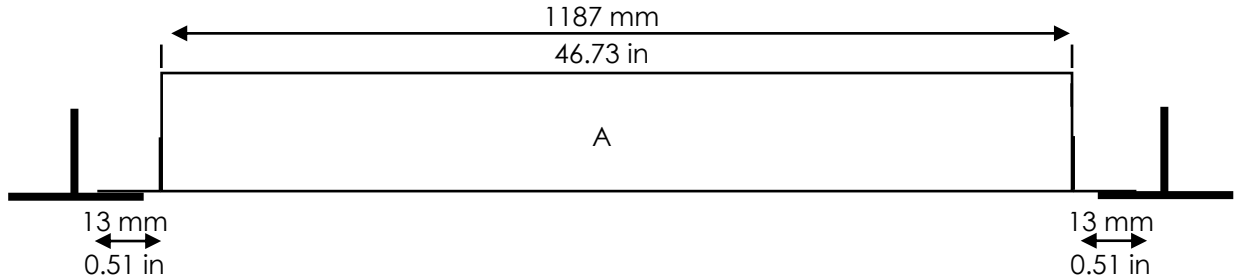

B – Starter & Ender

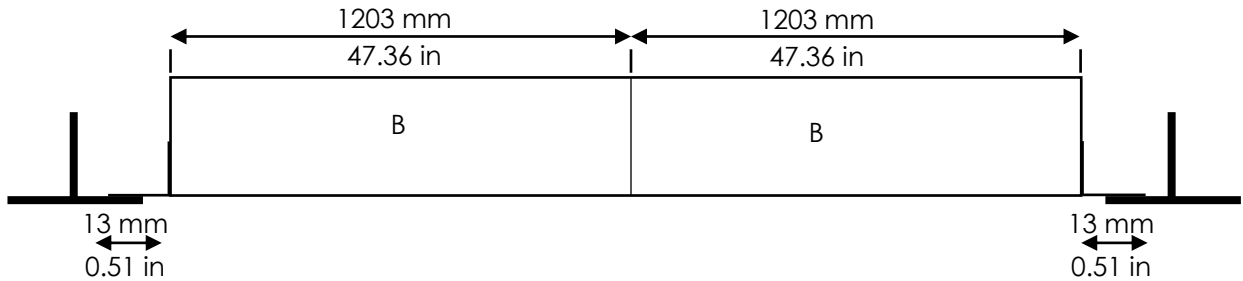

C – Middle

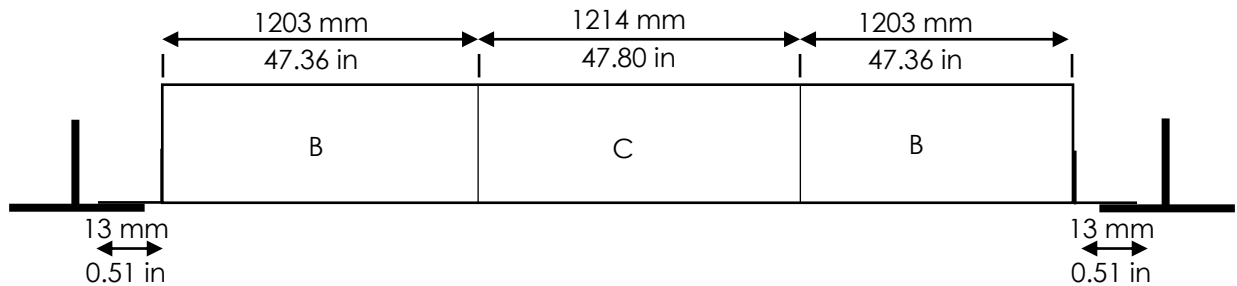

CROSS DIMENSIONS

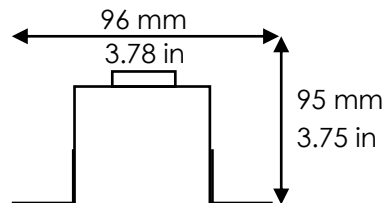
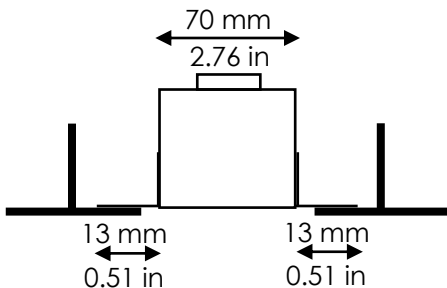

G5 Recessed T-grid

LINEAR FIXTURES

Linear Architectural Lighting

DATE	
PROJECT NAME	
TYPE	
QTY	
ORDERING CODE	AE-SF-G5CA 010 -R-

PRODUCT DIMENSION – 5FT

A – Stand alone

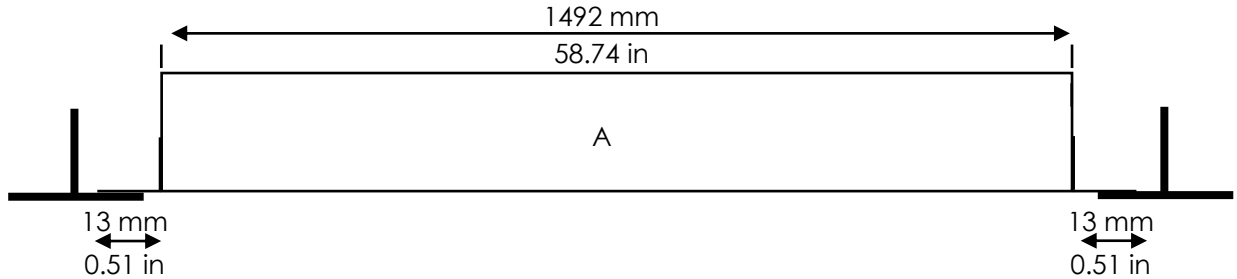

B – Starter & Ender

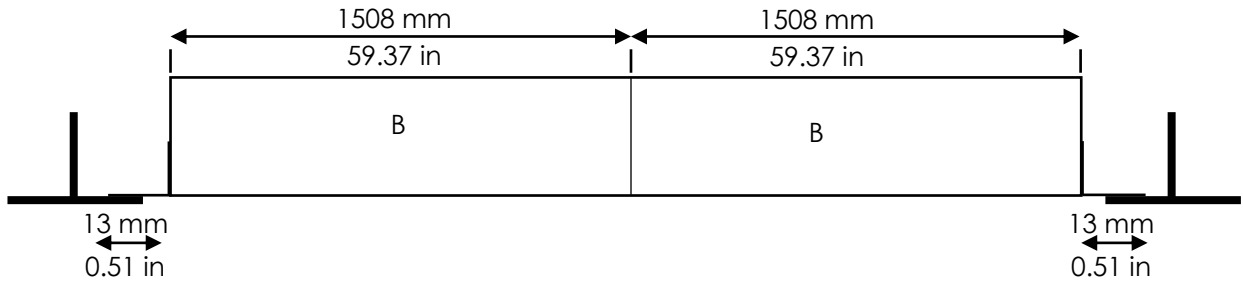

C – Middle

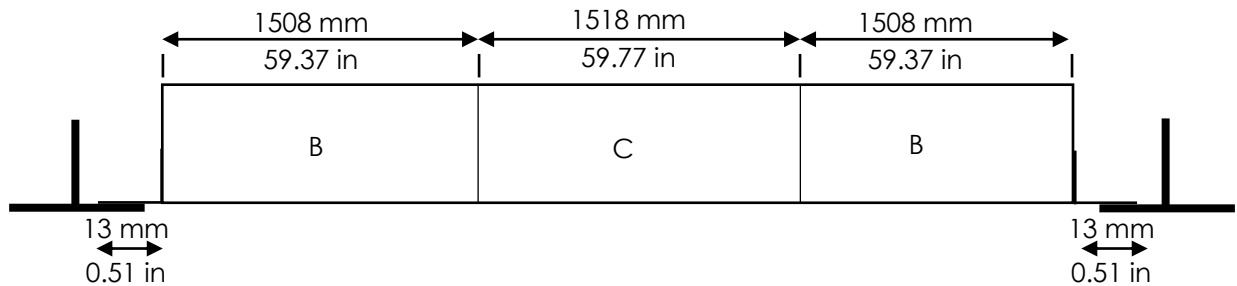

CROSS DIMENSIONS

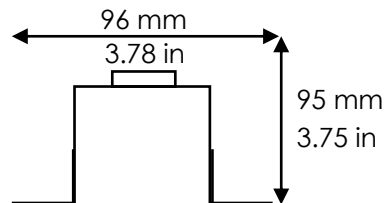
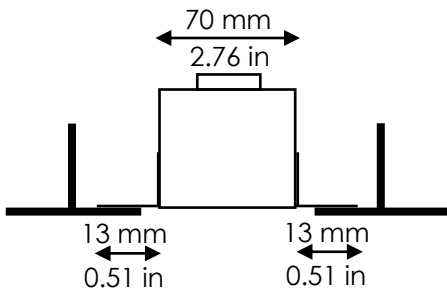

G5 Recessed T-grid

LINEAR FIXTURES

Linear Architectural Lighting

DATE	
PROJECT NAME	
TYPE	
QTY	
ORDERING CODE	AE-SF-G5CA 010 -R-

PRODUCT DIMENSION – 6FT

A – Stand alone

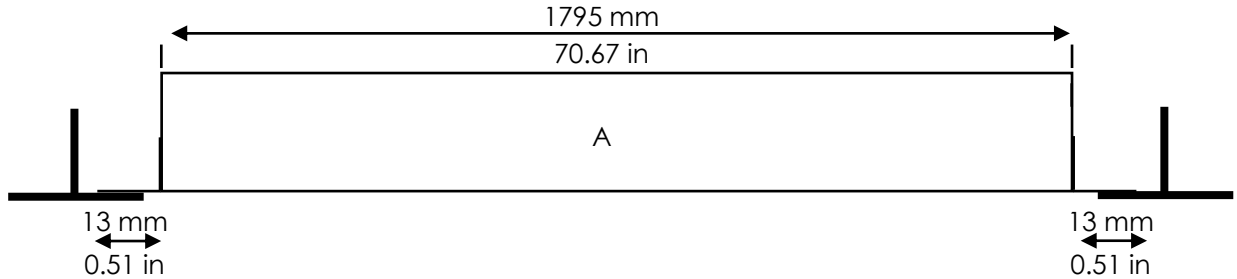

B – Starter & Ender

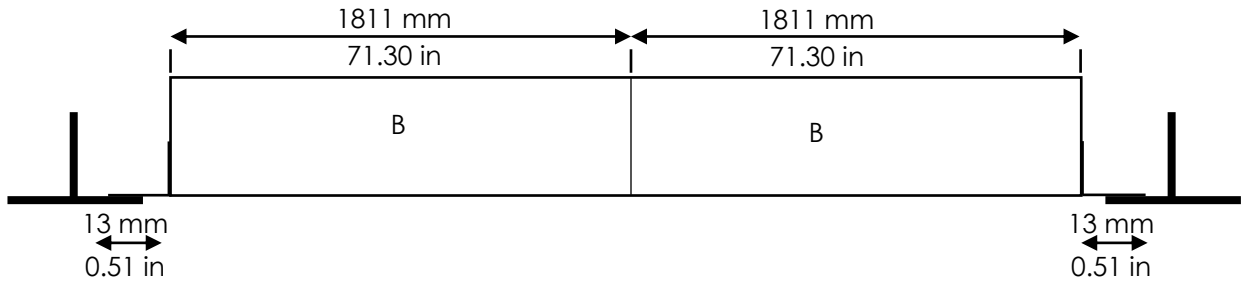

C – Middle

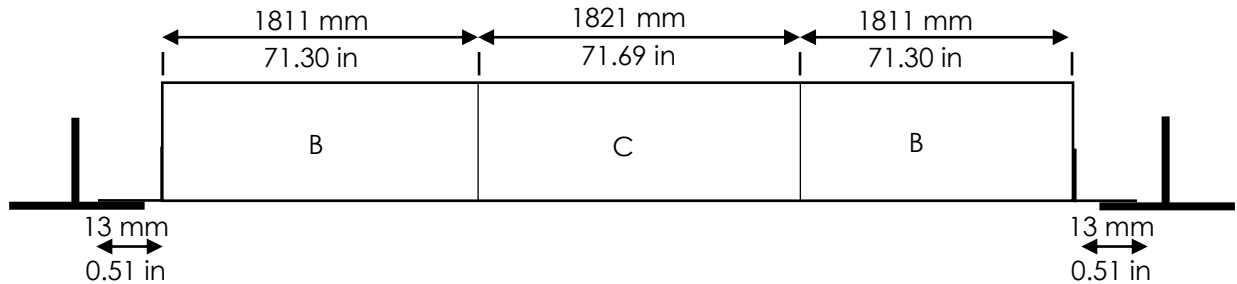

CROSS DIMENSIONS

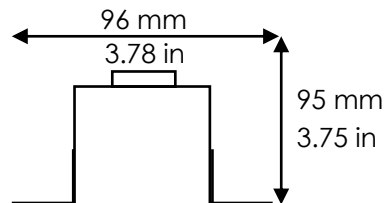
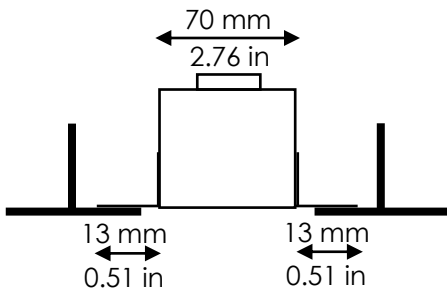

G5 Recessed T-grid

LINEAR FIXTURES

Linear Architectural Lighting

DATE	
PROJECT NAME	
TYPE	
QTY	
ORDERING CODE	AE-SF-G5CA 010 -R-

PRODUCT DIMENSION – 8FT

A – Stand alone

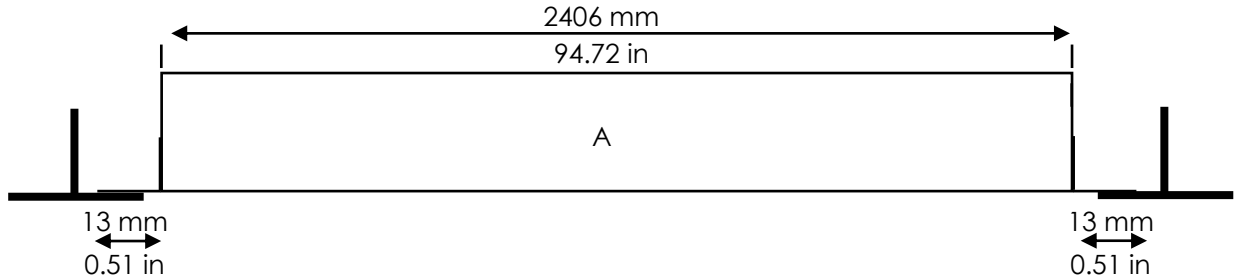

B – Starter & Ender

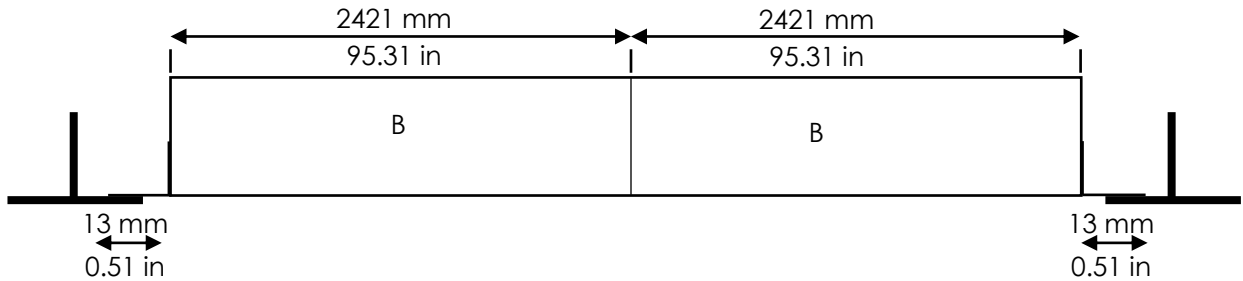

C – Middle

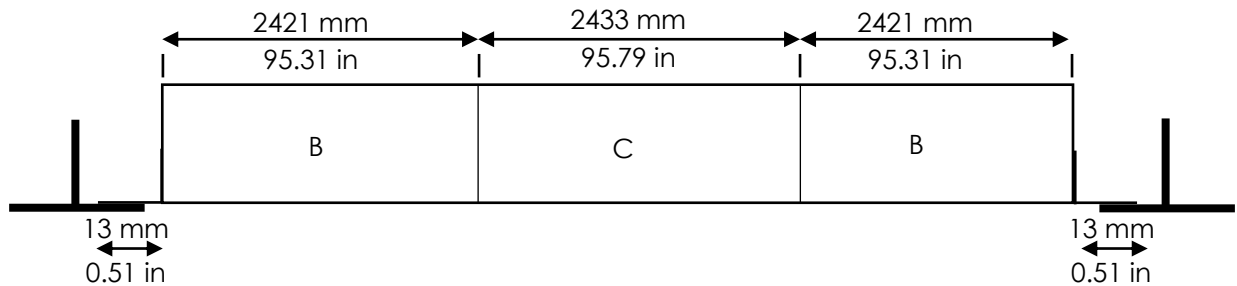

CROSS DIMENSIONS

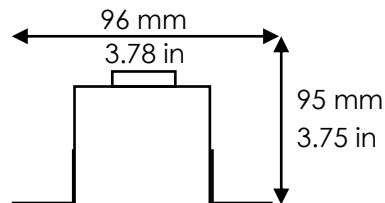
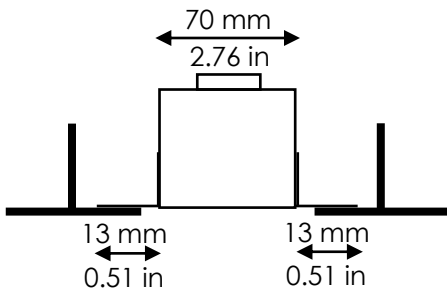

G5 Recessed T-grid

LINEAR FIXTURES

Linear Architectural Lighting

DATE	
PROJECT NAME	
TYPE	
QTY	
ORDERING CODE	AE-SF-G5CA 010 -R-

PHOTOMETRIC DATA

AE-SF-
G5CA44030/35/40010XX-GB
(3000K)

4 FEET

40 WATTS

4000K

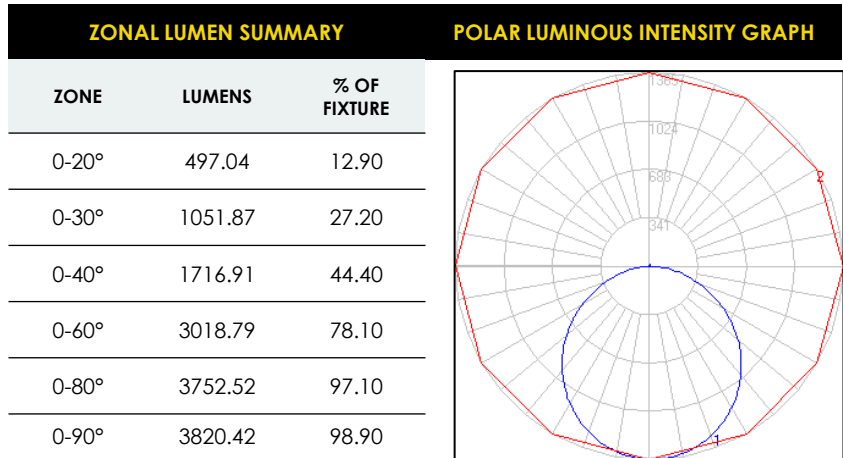

AE-SF-
G5CA44030/35/40010XX-GB
(4000K)

4 FEET

40 WATTS

4000K

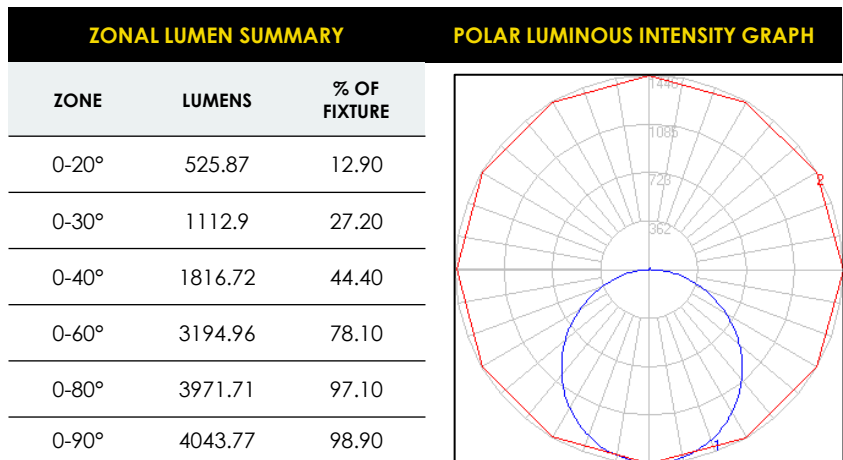

DIMMER COMPATIBILITY LIST

0-10V Dimmer
LEGRAND RH4FBL3PTC
LUTRON DVS7V-WH
LEVITON IP710-LFZ

0-10V Dimmer
EATON WBSD-010SLD
LEVITON DS710
LUTRON MS-Z101
HUBBEL LHDIRS3N

G5 Recessed T-grid

LINEAR FIXTURES

Linear Architectural Lighting

DATE					
PROJECT NAME					
TYPE					
QTY					
ORDERING CODE	AE-SF-G5CA			010	-R-

OVERVIEW



Easily removable fixture top

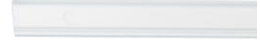

Mounting Bracket



Link



Mounting Bracket



Power Cord

ACCESSORIES

Adjustable mounting brackets ensure safe and easy installation on T-grids.

COLOR SELECTABLE

Use the exposed DIP switch to change between 3 CCT variations from warm to cool light.

CONTINUOUS RUNS

Easily connect multiple fixtures together for continuous mounting configuration.

FINISHES

Standard ERALUX anti-glare white and black finishes reduce object glare and provide an elegant look to the fixture's housing.