

G5

LINEAR LED LIGHT

Wall Mount Linear | 2.5" Aperture | Direct

What we have done with the 2nd generation of our most popular fixture is take customers' feedback into consideration. Now with a remolded housing that meets the modern project space, the G5's housing can be connected seamlessly in both light and fixture appearance. Available for suspended mounting, surface mounting, and wall mounting in various run lengths.

Applications: Art Galleries | Office | Retail Stores | Hospitality.

| | DATE | QTY | ACC. QTY | TYPE |
|--------------|------|-----|----------|------|
| PROJECT | | | | |
| PN | | | | |
| ACCESSORY PN | | | | |
| NOTES | | | | |

| DYNAMIC MENU | |
|-------------------|------------------------|
| Order Information | Page 2 |
| Dimensions | Page 4 |
| Accessories | Page 5 |
| Photometric Data | Page 8 |

[Install Instruction link](#)

SPECIFICATIONS

| | | |
|--------------------------------|--|------------|
| Input Voltage | 120-277/347V | |
| Power Factor | >0.9 | |
| Total Harmonic Distortion | <20% | |
| Dimming Page 3 | 0-10V dimming | |
| CRI | 80 CRI | |
| CCT | <div style="display: flex; justify-content: space-around;"> <div style="border: 1px solid black; border-radius: 50%; width: 20px; height: 20px; background-color: #fff9c4; display: flex; align-items: center; justify-content: center;">30K</div> <div style="border: 1px solid black; border-radius: 50%; width: 20px; height: 20px; background-color: #e1bee7; display: flex; align-items: center; justify-content: center;">35K</div> <div style="border: 1px solid black; border-radius: 50%; width: 20px; height: 20px; background-color: #bbdefb; display: flex; align-items: center; justify-content: center;">40K</div> <div style="border: 1px solid black; border-radius: 50%; width: 20px; height: 20px; background-color: #cfe2f3; display: flex; align-items: center; justify-content: center;">50K</div> </div> | |
| Efficacy | ~105-120 LPW | 1312 lm/ft |
| Length | 2ft 3ft 4ft 5ft 6ft 8ft | |
| Power(W) | 20W 30W 40W 50W 60W 80W | |
| Ambient Temperature Range | -10°C to 40°C | |
| Mounting Options | <div style="display: flex; align-items: center;"> <div style="width: 10px; height: 10px; background-color: #0070c0; margin-right: 5px;"></div> Wall mount </div> | |
| Fixture Finish | Black White Silver Gun powder <div style="display: flex; justify-content: space-around;"> <div style="border: 1px solid black; border-radius: 50%; width: 20px; height: 20px; background-color: black;"></div> <div style="border: 1px solid black; border-radius: 50%; width: 20px; height: 20px; background-color: white;"></div> <div style="border: 1px solid black; border-radius: 50%; width: 20px; height: 20px; background-color: #ccc;"></div> <div style="border: 1px solid black; border-radius: 50%; width: 20px; height: 20px; background-color: #444;"></div> </div> | |
| Optics | Polycarbonate Drop lens Wall Wash Parabolic louver | |
| Custom Design | Custom run L shape (inner/outer corner) | |
| Distribution | 120° | |



PRODUCT FEATURES



PRODUCT CERTIFICATIONS



Design Lights Consortium® (DLC) qualified product. Not all versions of this product may be DLC qualified. Please check the DLC Qualified Products List at www.designlights.org/QPL to confirm which versions are qualified" [page 3](#)

SYSTEM WARRANTY – 5 YEARS

Eralux will warrant defective drivers, LEDs and boards for 5 years from the date of purchase. This warranty is valid only if the fixture is installed and used as per installation guides and specifications. If a defect is present, Eralux will send drivers and boards at no fee with a thorough replacement instructions along with instructions on the return of the defective parts back to Eralux.

LUMEN MAINTENANCE – L85 at 50,000 hours

Rated for 85% initial lumen output at 50,000 hours of operation, operated at 25°C ambient temperature; per guidelines published by the Illuminating Engineering Society (IES).

LINEAR LED LIGHT

Wall Mount Linear | 2.5" Aperture | Direct



ORDERING GUIDE

| AE-SF-G5CA | | | 010 | | WM | | |
|----------------------------|--|-----------------------------|------------|-----------------------|--------------|--------------------------|------------------------------|
| AE-SF-G5CA | 2 20 | 30/35/40¹ | 010 | WH | WM | [BLANK] | [BLANK] |
| ERALUX G5 | 2ft 20W 2100lm | 3000/3500/4000K | 0-10V | White | Wall Mounted | No Option | Standard Polycarbonate |
| Wall Mounted | 3 30 | selectable | | BK | | LDE1³ | |
| Architectural Linear | 3ft 30W 3150lm | 30/40/50 | | Black | | Fade-to-Black down to 1% | -P |
| | 4 40 | 3000/4000/5000K selectable | | SV² | | | Prime Parabolic silver |
| 120-277/347V Input Voltage | 4ft 40W 4200lm | | | Silver | | EMBB⁴ | -PS |
| | 5 50 | | | GN² | | Emergency Battery Backup | Prime Shadow Parabolic Black |
| | 5ft 50W 4400lm | | | Gun Powder | | 1DIM⁵ | -DL |
| | 6 60 | | | | | 1% Dimming | 0.5" Drop |
| | 6ft 60W 6000lm | | | | | | -WW |
| | 8 80 | | | | | | Wall Wash |
| | 8ft 80W 8400lm | | | | | | |
| | C | | | | | | |
| | Continuous length increment of 1ft (Select or type the length then click on 'C') | | | | | | |

| Fixture Family | Length Power | CCT | Control | Finish | Mounting | Option | Diffuser |
|----------------|----------------|-----|---------|--------|----------|--------|----------|
|----------------|----------------|-----|---------|--------|----------|--------|----------|

NOTES

1. Default CCT setting is 3500K but can be changed upon request before shipping.
 2. Only available with Polycarbonate diffusers
 3. LDE1 is a Lutron Hi-lume EcoSystem driver with Soft-on, it requires color selection, if not the default CCT is 3500K.
 4. EMBB option available in 120-277V only.
 5. 1DIM available only in 120-277V, it works for 4,5,6,8 FT
- L-shape are available, contact factory for more information



ORDERING GUIDE – TRIAC Dimming

| AE-SF-G5CA | | | -TRI | |
|--|--------------------|-----------|---------------|---------------|
| ERALUX G5 Linear Architectural Fixture | 2 15 | 30 | -TRI | -WH-GB |
| | 2ft 15W 1575lm | 3000K | TRIAC Dimming | White |
| | 4 40 | 35 | | -BK-GB |
| | 4ft 40W 4250lm | 3500K | | Black |
| | 8 80 | 40 | | |
| | 8ft 80W 9600lm | 4000k | | |

| Fixture Family | Length Power | CCT | Controls | Finish |
|----------------|----------------|-----|----------|--------|
|----------------|----------------|-----|----------|--------|

CAUTION

- If there are multiple fixtures connected to the same 0-10V dimming line, a 0-10V controller must be considered to enable consistent dimming across the fixtures. Failure to do so will lead to inconsistent dimming and behaviors in the fixtures. Single switch is not recommended for controlling multiple fixtures simultaneously.
- Maximum of 300W per electrical drop.

LINEAR LED LIGHT

Wall Mount Linear | 2.5" Aperture | Direct

LUMEN OUTPUT

Efficacy: 110 LPW, 1100 lm/ft

| LENGTH | OUTPUT POWER |
|--------|---------------|
| 2FT | 15W 1650 lm |
| | 20W 2200 lm |
| 3FT | 30W 3300 lm |
| 4FT | 30W 3300 lm |
| | 40W 4400 lm |

| LENGTH | OUTPUT POWER |
|--------|---------------|
| 5FT | 35W 3850 lm |
| | 50W 5500 lm |
| 6FT | 35W 3850 lm |
| | 50W 5500 lm |
| | 60W 6600 lm |
| 8FT | 60W 6600 lm |
| | 80W 8800 lm |



| G5 | | | |
|-------------------------------|------------|----------------------------------|----------------|
| DLC MODEL | PRODUCT ID | Primary Use | Classification |
| AE-SF-G5CA22030-35-40010YY-GB | S-JTRUD | Direct Linear Ambient Luminaires | Standard |
| AE-SF-G5CA44030-35-40010YY-GB | S-ACNDT2 | | Standard |
| AE-SF-G5CA87030-35-40010YY-GB | S-09HDJM | | Standard |

DIMMER COMPATIBILITY LIST

0-10V Dimming

| BRAND | MODEL | BRAND | MODEL |
|---------|-----------|---------|-------------|
| LEVITON | IP710-LFZ | LEGRAND | RH4FBL3PTC |
| | DS710 | EATON | WBSD-010SLD |
| LUTRON | DVS7V-WH | HUBBLE | LHDIRS3N |
| | MS-Z101 | | |

LINEAR LED LIGHT

Wall Mount Linear | 2.5" Aperture | Direct

DIMENSIONS

| SIZE | TOP/BOTTOM VIEW | SIDE VIEW |
|------|-----------------|-----------|
| 2FT | | |
| 3FT | | |
| 4FT | | |
| 5FT | | |
| 6FT | | |
| 8FT | | |

DRILLING PATTERN

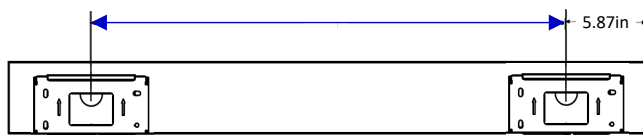

| SIZE | STAND ALONE INSTALLATION |
|------|--------------------------|
| 2FT | 12 in |
| 3FT | 23.9 in |
| 4FT | 35.5 in |
| 5FT | 47.6 in |
| 6FT | 59 in |
| 8FT | 82.6 in |

LINEAR LED LIGHT

Wall Mount Linear | 2.5" Aperture | Direct

ACCESSORIES

Ordered separately if needed

POWER CORD

| ORDER CODE | DESCRIPTION | PICTURE |
|--|--|---------|
| AE-SF-PWRCORD-WH AE-SF-PWRCORD-BK | 8' white / black power cord with 120-277V input voltage | |
| AE-SF-PWRCORD-WH-18FT AE-SF-PWRCORD-BK-18FT | 18' white / black power cord with 120-277V input voltage | |
| AE-SF-PWRCORD-HV-WH AE-SF-PWRCORD-HV-BK | 8' white / black power cord with 120-347V input voltage | |
| AE-SF-PWRCORD-HV-WH-18FT AE-SF-PWRCORD-HV-BK-18FT | 18' white / black power cord with 120-347V input voltage | |

G3-LINK

| ORDER CODE | DESCRIPTION |
|---------------|---|
| AE-SF-G3-LINK | Seamless mechanical connection for continuous runs Preventing Light Leakage Easy installation |

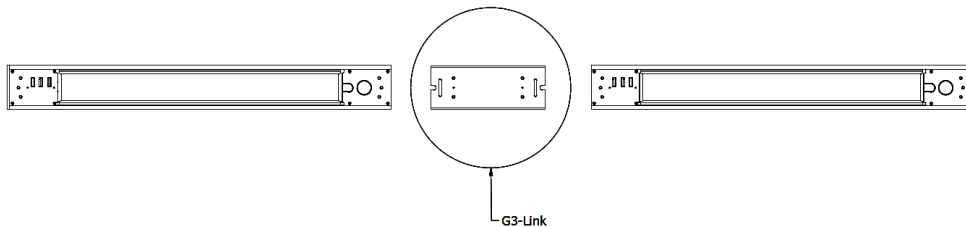

WALL MOUNTING

| Description | Pictures |
|--------------|----------|
| AE-SF-WMB-WH | |
| AE-SF-WMB-BK | |

LINEAR LED LIGHT

Wall Mount Linear | 2.5" Aperture | Direct

LENS OPTIONS

DROP LENS

ORDER CODE

DESCRIPTION

PICTURE

AE-SF-G5/SPT-DROP LENS-0.5 INCH-XFT-WH
AE-SF-G5/SPT-Drop Lens-0.5 inch-XFT-BK

(X = 2, 4, 6 or 8)

Highly durable frosted polycarbonate lens provides glowing sides with crisp corners visible at a distance. This drop lens gives a 3D look to the light that will enliven your space and add wider spread to the surroundings.

Available sizes: 2FT, 4FT, 6FT, and 8FT.
23% less lumens. 0.5" thickness.

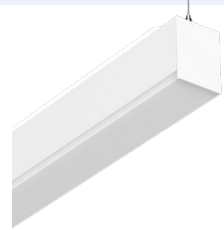

WALL WASH LENS

ORDER CODE

DESCRIPTION

PICTURE

AE-SF-G5/SPT-XFT-WW-KIT-WH
AE-SF-G5/SPT-XFT-WW-KIT-BK

(X = 2, 4, 5, 6 or 8)

Wall washing is a feature where the luminaire is typically positioned at least 12" from the wall to enhance the smoothness of a wall by eliminating shadows or to highlight a wall to create visual interest.

Available sizes: 2FT, 4FT, 5FT, 6FT, and 8FT.

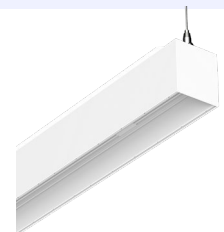

PRIME LENS

ORDER CODE

DESCRIPTION

PICTURE

Order using ordering guide. [Page 2](#)

The prime lens features a parabolic silver louver that offers outstanding light shielding and an attractive, crisp visual texture. Its parabolic blade design, along with side reflectors, effectively directs light, enhancing brightness and efficiency in lighting applications. The prime delivers a modern, sleek look, making it suitable for contemporary spaces.

Available sizes: 2FT, 4FT, 5FT, 6FT, and 8FT.
Efficacy: ~90Lm/W | UGR: 13.9 - 15.7



PRIME SHADOW LENS

ORDER CODE

DESCRIPTION

PICTURE

Order using ordering guide. [Page 2](#)

The prime shadow lens features a parabolic black louver that offers outstanding light shielding and an attractive, crisp visual texture. Its black parabolic blade design, along with side reflectors, effectively reduces glare by absorbing more light. Black louvers can create a more dramatic or industrial aesthetic, fitting well in design contexts.

Available sizes: 2FT, 4FT, 5FT, 6FT, and 8FT.
Efficacy: ~55Lm/W | UGR: 18.3 - 20.4



LINEAR LED LIGHT

Wall Mount Linear | 2.5" Aperture | Direct

CONTROLS

EMERGENCY LED DRIVER (BLD-YTXXD-XXX)

BLD-YT08D-XXX

BLD-YT15D-XXX



The BLD-YTXXD-XXX series LED Emergency Driver is UL listed for field and factory installations. It switches to emergency mode during power failures, providing up to 90 minutes of lighting. With an integrated battery, charger, and converter, it delivers 8 or 15W constant power at 30-60VDC. Its slim shape is ideal for use in linear LED lighting fixtures.

SPECIFICATIONS

| | |
|----------------------------|---------------|
| Input Voltage | 30-60VDC |
| Power Frequency | 50/60HZ |
| Output Voltage | 30-60VDC |
| Output Power | 8W 15W |
| Ambient Temperature | 0°C to 50°C |
| | 30°F to 122°F |
| Installation | Integrated |

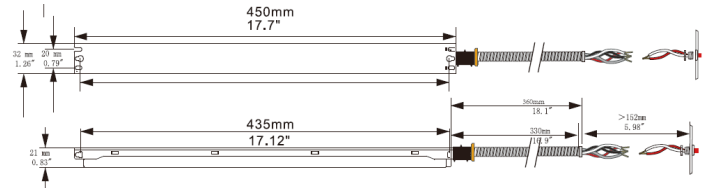
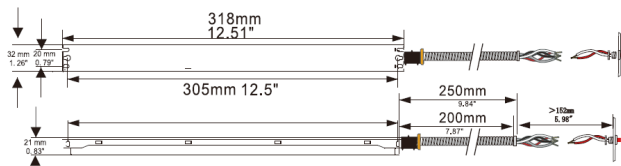

ROOM OCCUPANCY SENSOR

Ordered separately, field installed

| PART NUMBER | DESCRIPTION |
|-------------|---------------------------------|
| AE-CT-DT806 | Detecta - Room Occupancy Sensor |
| RC102 | RC102 Remote Control |

SPECIFICATIONS

| | | |
|------------------------|------------------|-------|
| Input Voltage | 120-277 Vac | |
| Power Frequency | 50/60HZ | |
| Rated Load | At 120 Vac | 800W |
| | At 277 Vac | 1200W |
| Detection Range | 3-10 Meters | |
| | 9.8- 32.8 Feet | |
| Standby Power | ~0.9W | |
| Time Setting | 10 sec to 30 min | |
| Light Control | 10-2,000LUX | |
| Installation | Ceiling Mounted | |

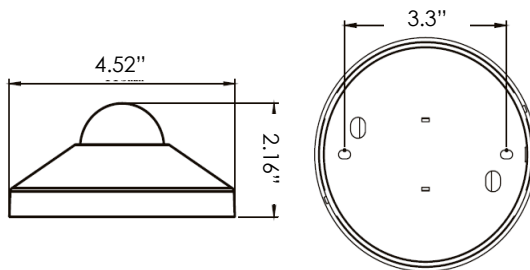

LINEAR LED LIGHT

Wall Mount Linear | 2.5" Aperture | Direct

LUMEN ESTIMATE

Lumen output varies based on CCT and CRI. Use correction factors as per table below:

LUMEN ESTIMATE ADJUSTMENT FACTORS

| CCT | 3000K | 3500K | 4000K | 5000K |
|-----------------|-------|-------|-------|-------|
| PREMIUM (90CRI) | 0.94 | 0.97 | 1 | 1.03 |

PHOTOMETRIC DATA

| PART NUMBER | | ZONAL LUMEN SUMMARY | | | POLAR LUMINOUS INTENSITY | CONE DISTRIBUTION | | | |
|----------------------|-------|---------------------|---------|-----------|---|-------------------|---------|---------|---------|
| AE-SF-G5CA220 | | Zone | Lumens | % Fixture | | Center Beam Fc | | | |
| Wattage | 20W | 0-20° | 294.61 | 12.90 | | 1.7R | 280 fc | 5.0 ft | 4.8 ft |
| CCT | 4000K | 0-30° | 623.47 | 27.20 | | 3.3R | 74.3 fc | 9.7 ft | 9.3 ft |
| Distribution | 120° | 0-40° | 1017.77 | 44.40 | | 5.0R | 32.4 fc | 14.8 ft | 14.0 ft |
| Length | 2ft | 0-60° | 1789.99 | 78.10 | | 6.7R | 18 fc | 19.8 ft | 18.8 ft |
| | | 0-80° | 2225.05 | 97.10 | | 8.3R | 11.7 fc | 24.5 ft | 23.3 ft |
| | | 0-90° | 2265.42 | 98.90 | 10.0R | 8.09 fc | 29.5 ft | 28.1 ft | |
| | | | | | ■ Vert. Spread: 111.7° ■ Horiz. Spread: 109.1° | | | | |
| AE-SF-G5CA440 | | Zone | Lumens | % Fixture | | Center Beam Fc | | | |
| Wattage | 40W | 0-20° | 525.87 | 12.9 | | 1.7R | 500 fc | 5.0 ft | 4.8 ft |
| CCT | 4000K | 0-30° | 1112.9 | 27.2 | | 3.3R | 133 fc | 9.7 ft | 9.3 ft |
| Distribution | 120° | 0-40° | 1816.72 | 44.4 | | 5.0R | 57.8 fc | 14.8 ft | 14.0 ft |
| Length | 4ft | 0-60° | 3194.96 | 78.1 | | 6.7R | 32.2 fc | 19.8 ft | 18.8 ft |
| | | 0-80° | 3971.71 | 97.1 | | 8.3R | 21 fc | 24.5 ft | 23.3 ft |
| | | 0-90° | 4043.77 | 98.9 | 10.0R | 14.4 fc | 29.5 ft | 28.1 ft | |
| | | | | | ■ Vert. Spread: 111.7° ■ Horiz. Spread: 109.1° | | | | |
| AE-SF-G5CA660 | | Zone | Lumens | % Fixture | | Center Beam Fc | | | |
| Wattage | 60W | 0-20° | 751.25 | 12.9 | | 1.7R | 714 fc | 5.0 ft | 4.8 ft |
| CCT | 4000K | 0-30° | 1589.85 | 27.2 | | 3.3R | 189 fc | 9.7 ft | 9.3 ft |
| Distribution | 120° | 0-40° | 2595.32 | 44.4 | | 5.0R | 82.5 fc | 14.8 ft | 14.0 ft |
| Length | 6ft | 0-60° | 4564.23 | 78.1 | | 6.7R | 46 fc | 19.8 ft | 18.8 ft |
| | | 0-80° | 5673.88 | 97.1 | | 8.3R | 29.9 fc | 24.5 ft | 23.3 ft |
| | | 0-90° | 5776.82 | 98.9 | 10.0R | 20.6 fc | 29.5 ft | 28.1 ft | |
| | | | | | ■ Vert. Spread: 111.7° ■ Horiz. Spread: 109.1° | | | | |
| AE-SF-G5CA880 | | Zone | Lumens | % Fixture | | Center Beam Fc | | | |
| Wattage | 80W | 0-20° | 981.56 | 12.90 | | 1.7R | 933 fc | 5.0 ft | 4.8 ft |
| CCT | 4000K | 0-30° | 2077.26 | 27.20 | | 3.3R | 248 fc | 9.7 ft | 9.3 ft |
| Distribution | 120° | 0-40° | 3390.97 | 44.40 | | 5.0R | 108 fc | 14.8 ft | 14.0 ft |
| Length | 8ft | 0-60° | 5963.5 | 78.10 | | 6.7R | 60 fc | 19.8 ft | 18.8 ft |
| | | 0-80° | 7413.33 | 97.10 | | 8.3R | 39.1 fc | 24.5 ft | 23.3 ft |
| | | 0-90° | 7547.83 | 98.90 | 10.0R | 27 fc | 29.5 ft | 28.1 ft | |
| | | | | | ■ Vert. Spread: 111.7° ■ Horiz. Spread: 109.1° | | | | |

LINEAR LED LIGHT

Wall Mount Linear | 2.5" Aperture | Direct

PHOTOMETRIC DATA - DIFFUSER

| PART NUMBER | | ZONAL LUMEN SUMMARY | | | POLAR LUMINOUS INTENSITY | CONE DISTRIBUTION | | | |
|---------------------------|-------|---------------------|---------|-----------|--------------------------|-------------------|---------|------------|---------|
| AE-SF-G5CA44030/35/40X-DL | | Zone | Lumens | % Fixture | Direct Light | Center Beam Fc | | Beam Width | |
| Wattage | 40W | 0-20° | 420.45 | 11.9 | | 2.5ft | 186 fc | 6.5 ft | 7.2 ft |
| CCT | 4000K | 0-30° | 882.52 | 24.9 | | 5.0ft | 46.6 fc | 12.9 ft | 14.5 ft |
| Distribution | 120° | 0-40° | 1428.38 | 40.4 | | 7.5ft | 20.7 fc | 19.4 ft | 21.7 ft |
| Length | 4ft | 0-60° | 2493.86 | 70.5 | | 10.0ft | 11.6 fc | 25.8 ft | 28.9 ft |
| DROP LENS | | 0-80° | 3150.06 | 89 | | 12.5ft | 7.45 fc | 32.3 ft | 36.2 ft |
| | | 0-90° | 3267.17 | 92.3 | | 15.0ft | 5.17 fc | 38.7 ft | 43.4 ft |

| PART NUMBER | | ZONAL LUMEN SUMMARY | | | POLAR LUMINOUS INTENSITY | CONE DISTRIBUTION | | | |
|---------------------------|-------|---------------------|---------|-----------|--------------------------|-------------------|---------|------------|--------|
| AE-SF-G5CA45030/35/40X-WW | | Zone | Lumens | % Fixture | Direct Light | Center Beam Fc | | Beam Width | |
| Wattage | 50W | 0-20° | 931.99 | 13.4 | | 2.5ft | 347 fc | 3.5 ft | 1.4 ft |
| CCT | 4000K | 0-30° | 2174.46 | 31.3 | | 5.0ft | 86.8 fc | 6.9 ft | 2.8 ft |
| Distribution | 120° | 0-40° | 3457.33 | 49.8 | | 7.5ft | 38.6 fc | 10.4 ft | 4.1 ft |
| Length | 4ft | 0-60° | 4537.37 | 65.3 | | 10.0ft | 21.7 fc | 13.9 ft | 5.5 ft |
| WALL WASH LENS | | 0-80° | 4827.69 | 69.5 | | 12.5ft | 13.9 fc | 17.3 ft | 6.9 ft |
| | | 0-90° | 4850.9 | 69.8 | | 15.0ft | 9.65 fc | 20.8 ft | 8.3 ft |

| PART NUMBER | | ZONAL LUMEN SUMMARY | | | POLAR LUMINOUS INTENSITY | CONE DISTRIBUTION | | | |
|--------------------------|-------|---------------------|---------|-----------|--------------------------|-------------------|---------|------------|---------|
| AE-SF-G5CA44030/35/40X-P | | Zone | Lumens | % Fixture | Direct Light | Center Beam Fc | | Beam Width | |
| Wattage | 40W | 0-20° | 967.59 | 27.6 | | 2.5ft | 178 fc | 7.2 ft | 6.9 ft |
| CCT | 4000K | 0-30° | 1905.45 | 54.4 | | 5.0ft | 44.5 fc | 14.4 ft | 13.8 ft |
| Distribution | 120° | 0-40° | 2736.19 | 78.2 | | 7.5ft | 19.8 fc | 21.7 ft | 20.7 ft |
| Length | 4ft | 0-60° | 3454.72 | 98.7 | | 10.0ft | 11.1 fc | 28.9 ft | 27.6 ft |
| PRIME | | 0-80° | 3483.38 | 99.5 | | 12.5ft | 7.11 fc | 36.1 ft | 34.5 ft |
| | | 0-90° | 3485.56 | 99.6 | | 15.0ft | 4.94 fc | 43.3 ft | 41.5 ft |

| PART NUMBER | | ZONAL LUMEN SUMMARY | | | POLAR LUMINOUS INTENSITY | CONE DISTRIBUTION | | | |
|---------------------------|-------|---------------------|---------|-----------|--------------------------|-------------------|---------|------------|---------|
| AE-SF-G5CA44030/35/40X-PS | | Zone | Lumens | % Fixture | Direct Light | Center Beam Fc | | Beam Width | |
| Wattage | 40W | 0-20 | 523.96 | 23.4 | | 2.5ft | 233 fc | 3.1 ft | 5.1 ft |
| CCT | 4000K | 0-30 | 1069.19 | 47.8 | | 5.0ft | 58.4 fc | 6.3 ft | 10.3 ft |
| Distribution | 120° | 0-40 | 1601.34 | 71.6 | | 7.5ft | 25.9 fc | 9.4 ft | 15.4 ft |
| Length | 4ft | 0-60 | 2178.89 | 97.4 | | 10.0ft | 14.6 fc | 12.5 ft | 20.5 ft |
| PRIME SHADOW | | 0-80 | 2230.17 | 99.7 | | 12.5ft | 9.34 fc | 15.6 ft | 25.6 ft |
| | | 0-90 | 2231.01 | 99.8 | | 15.0ft | 6.49 fc | 18.8 ft | 30.8 ft |

LINEAR LED LIGHT

Wall Mount Linear | 2.5" Aperture | Direct

OVERVIEW



Innovative Design

- Extruded aluminum housing for better heat dissipation.
- Highly durable polycarbonate and high transmittance lens.

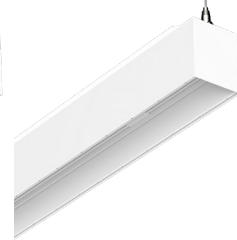
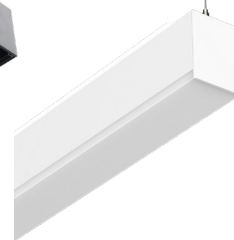

Diffusers

- Polycarbonate lens
- Wall-wash lens
- 0.5-inch drop lens
- Black/silver parabolic louver



Multiple Options

- Six standard lengths available: 2, 3, 4, 5, 6, & 8ft.
- Three CCT switchable and power tunable.
- Black, white, silver, & gun powder finishes.



Mountings Available

- Suspended (refer to the suspended spec sheet)
- Wall mount
- Surface mount (refer to the surface mount spec sheet)
- Recessed T-grid (refer to the recessed T-grid spec sheet)



Features

- 1% dimming option
- Lutron Hi-lume Ecosystem driver with Soft-on



Tests And Certifications

