

| | |
|--------------|--|
| DATE | |
| PROJECT NAME | |
| TYPE | |
| QTY | |
| NOTES | |

DESCRIPTION



120V 50/60 Hz 20A Max



ERALUX Track 1 is compatible with Juno single circuit Adapters.

Track / Power Distribution System is suitable for retail, commercial and residential use.

Ships with one T0009 (end cap) installed Extruded aluminum "I" beam. Thermoplastic insulator. Two #12 AWG solid copper conductors.

| LENGTH | PART NO. | LENGTH |
|--------|----------|------------------|
| 2' | T1-2 | 512 mm (20.16") |
| 4' | T1-4 | 1122 mm (44.17") |
| 6' | T1-6 | 1732 mm (68.19") |
| 8' | T1-8 | 2341 mm (92.17") |
| 12' | T1-12 | 3657.6 mm (144") |

ORDER CODE

Example: T1-2-WHT

| FAMILY | LENGTH | FINISH |
|--|-------------------------------|------------------------------|
| T1- | | - |
| T1- ERALUX T1 single circuit Juno compatible track systems | 2 2' track system | -WHT White Finish |
| | 4 4' track system | -BLK Black Finish |
| | 6 6' track system | -SLV Silver Finish |
| | 8 8' track system | |
| | 12 12' track system | |

WARRANTY

SYSTEM WARRANTY – 3 YEARS

Eralux will warrant defective drivers, LEDs and boards for 5 years from the date of purchase. This warranty is valid only if the fixture is installed and used as per installation guides and specifications. If a defect is present, Eralux will send drivers and boards at no fee with a thorough replacement instructions along with instructions on the return of the defective parts back to Eralux.

| | |
|--------------|--|
| DATE | |
| PROJECT NAME | |
| TYPE | |
| QTY | |
| NOTES | |

TRACK COMPONENTS



MINI I CONNECTOR

T10001



T CONNECTOR

T10002
T10002R (Reverse)



L CONNECTOR

T10003



X CONNECTOR

T10004



FLOATING CANOPY

T10005



CONDUIT END FEED

T10006
T10006R (Reverse)



FLEXIBLE CONNECTOR

T10007



END FEED KIT + COVER

T10008



END CAP

T10009

PRODUCT ORDERING COLOR CODES

WHITE (-WHT), BLACK (-BLK), SILVER (-SLV)

| | |
|--------------|--|
| DATE | |
| PROJECT NAME | |
| TYPE | |
| QTY | |
| NOTES | |

TRACK COMPONENTS



**PENDANT LUMINAIRE
ADAPTER, CHAIN**

T10010



**PENDANT LUMINAIRE
ADAPTER, CORD**

T10011



T-Bar Connector

T10012



T-Bar End Feed

T10013



**Mounting Accessory
For T-bar Grid Ceilings**

T10014



Top Access End Feed

T10015

T10015R (Reverse)



**Line Voltage Mono-
Point Adapter**

T10016



Duo-Point Adapters

T10017



**Line Voltage Sloped
Ceiling Adapter**

T10018

TRACK T1

TRACK ACCESSORIES & SYSTEM

| | |
|--------------|--|
| DATE | |
| PROJECT NAME | |
| TYPE | |
| QTY | |
| NOTES | |

TRACK COMPONENTS

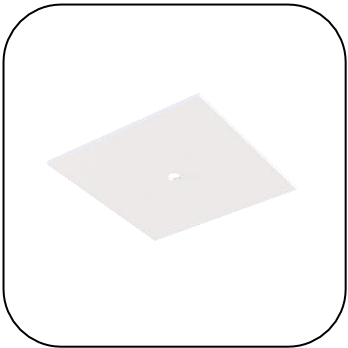

Cover Plate

T10020



Single Circuit End Feed

T10021



Single Circuit End Feed + 1' Track Attached

T10022



Single Circuit In-Line Feed

T10023

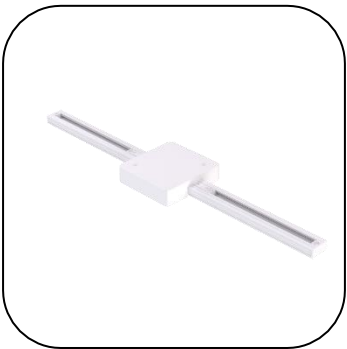

Single Circuit In-Line Feed + 1' Track Attached

T10024



Thin Single Circuit End Feed with 1' Track Attached

T10025



Thin Single Circuit End Feed

T10026

TRACK T10001

TRACK ACCESSORIES & SYSTEM

| | |
|--------------|--|
| DATE | |
| PROJECT NAME | |
| TYPE | |
| QTY | |
| NOTES | |

TRACK COMPONENTS

MINI I CONNECTOR



| Color | Ordering Code |
|--------|---------------|
| Black | T10001-BLK |
| White | T10001-WHT |
| Silver | T10001-SLV |

DIMENSIONS (in mm)

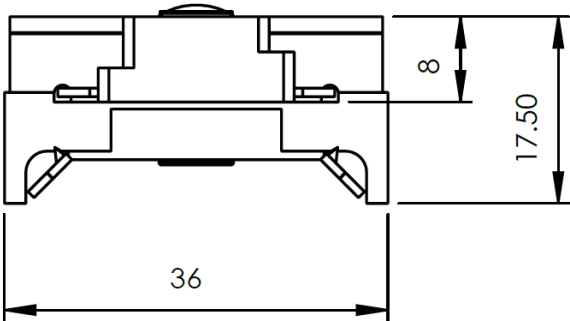
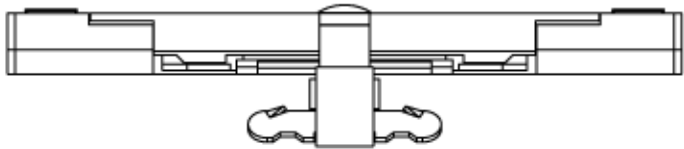
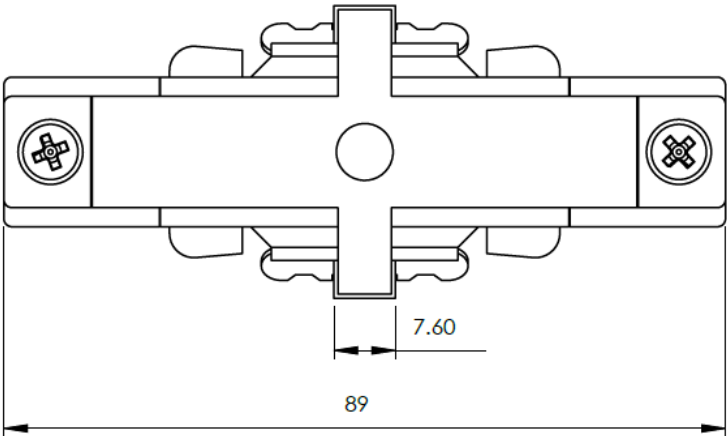

TRACK T10002

TRACK ACCESSORIES & SYSTEM

| | |
|--------------|--|
| DATE | |
| PROJECT NAME | |
| TYPE | |
| QTY | |
| NOTES | |

TRACK COMPONENTS

T CONNECTOR



| Color | Ordering Code |
|--------|---------------|
| Black | T10002-BLK |
| White | T10002-WHT |
| Silver | T10002-SLV |

DIMENSIONS (in mm)

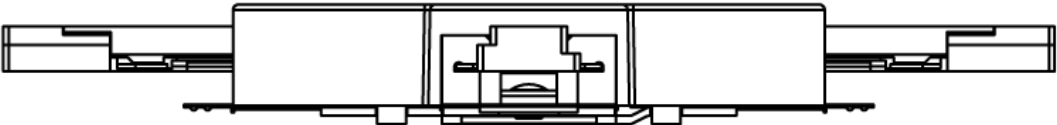
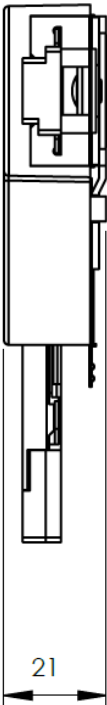
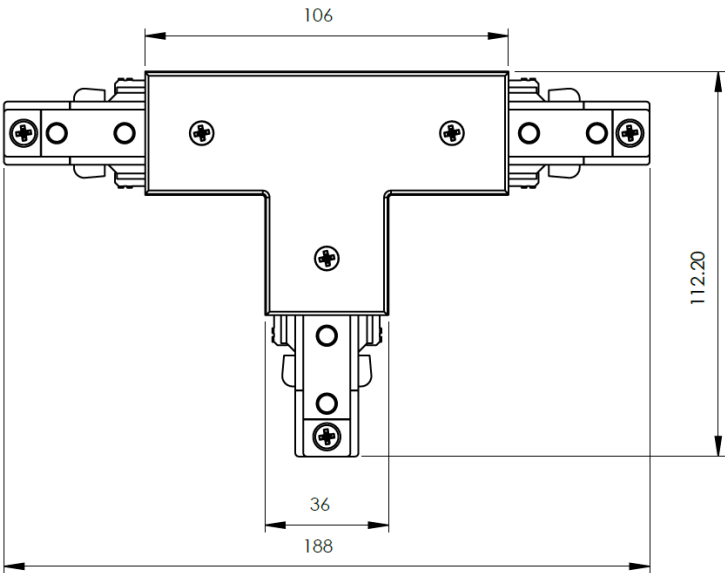

| | |
|--------------|--|
| DATE | |
| PROJECT NAME | |
| TYPE | |
| QTY | |
| NOTES | |

TRACK COMPONENTS

L CONNECTOR



| Color | Ordering Code |
|--------|---------------|
| Black | T10003-BLK |
| White | T10003-WHT |
| Silver | T10003-SLV |

DIMENSIONS (in mm)

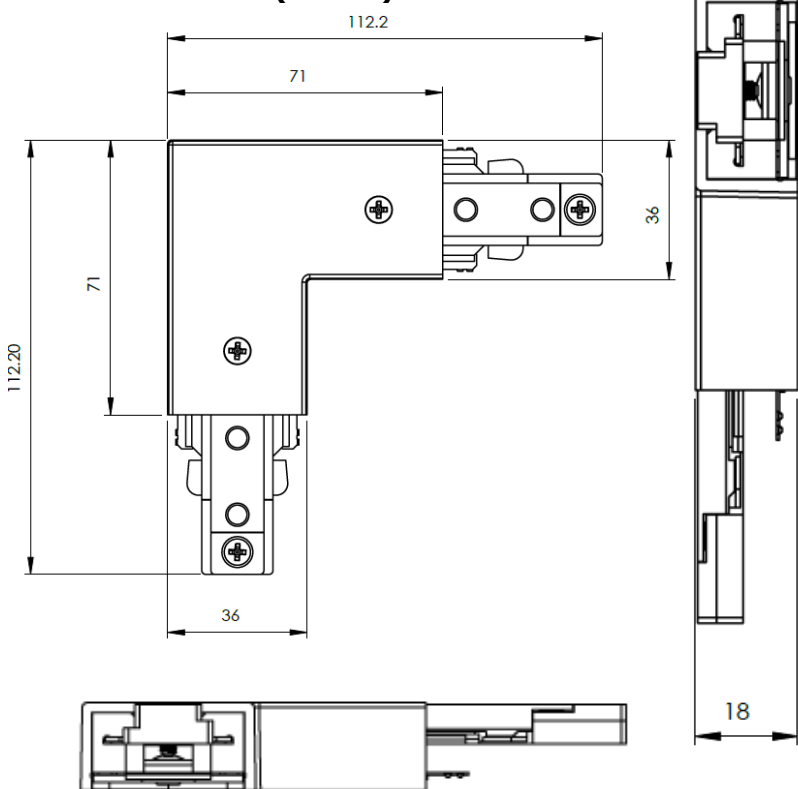

| Color | Ordering Code |
|-------|----------------------------|
| Black | AE-TS-LCONNECTOR-COVER-BK |
| White | AE-TS-LCONNECTOR-COVER-WHT |

* L CONNECTOR + COVER → STRAIGHT CONNECTOR + POWER FEED *

TRACK T10004

TRACK ACCESSORIES & SYSTEM

| | |
|--------------|--|
| DATE | |
| PROJECT NAME | |
| TYPE | |
| QTY | |
| NOTES | |

TRACK COMPONENTS

X CONNECTOR



| Color | Ordering Code |
|--------|---------------|
| Black | T10004-BLK |
| White | T10004-WHT |
| Silver | T10004-SLV |

DIMENSIONS (in mm)

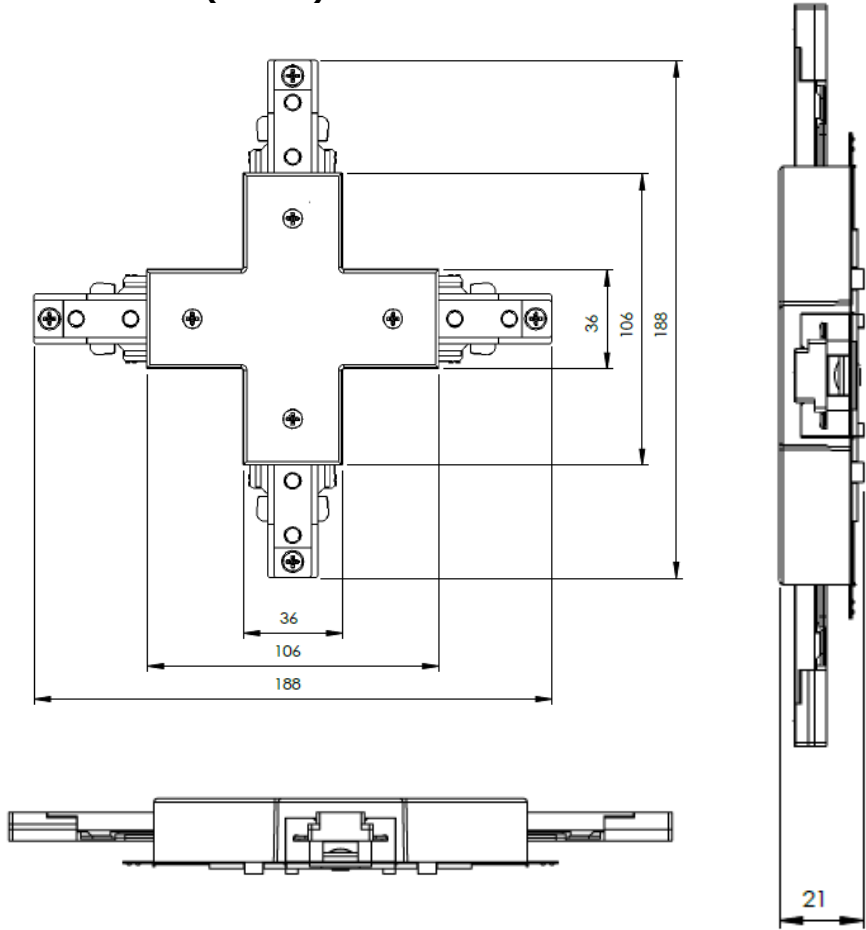

TRACK T10005

TRACK ACCESSORIES & SYSTEM

| | |
|--------------|--|
| DATE | |
| PROJECT NAME | |
| TYPE | |
| QTY | |
| NOTES | |

TRACK COMPONENTS

FLOATING CANOPY



| Color | Ordering Code |
|--------|---------------|
| Black | T10005-BLK |
| White | T10005-WHT |
| Silver | T10005-SLV |

DIMENSIONS (in mm)

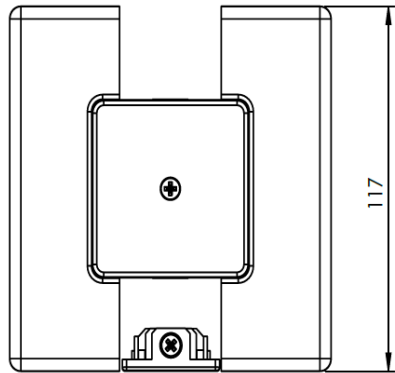
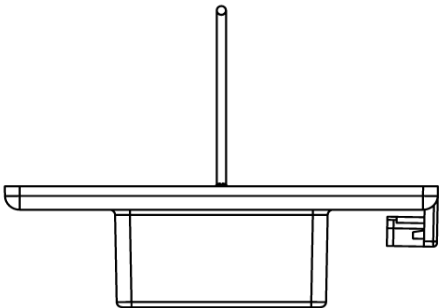
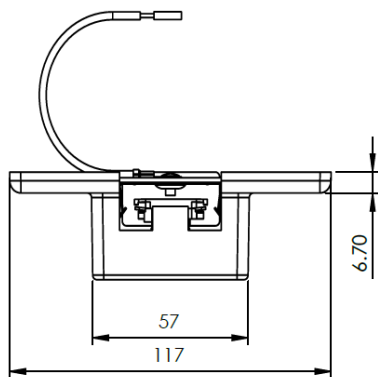

TRACK T1

TRACK ACCESSORIES & SYSTEM

| | |
|--------------|--|
| DATE | |
| PROJECT NAME | |
| TYPE | |
| QTY | |
| NOTES | |

TRACK COMPONENTS

CONDUIT END FEED



| Color | Ordering Code |
|--------|---------------|
| Black | T10006-BLK |
| White | T10006-WHT |
| Silver | T10006-SLV |

DIMENSIONS (in mm)

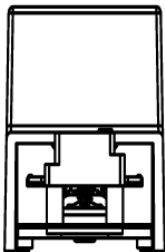
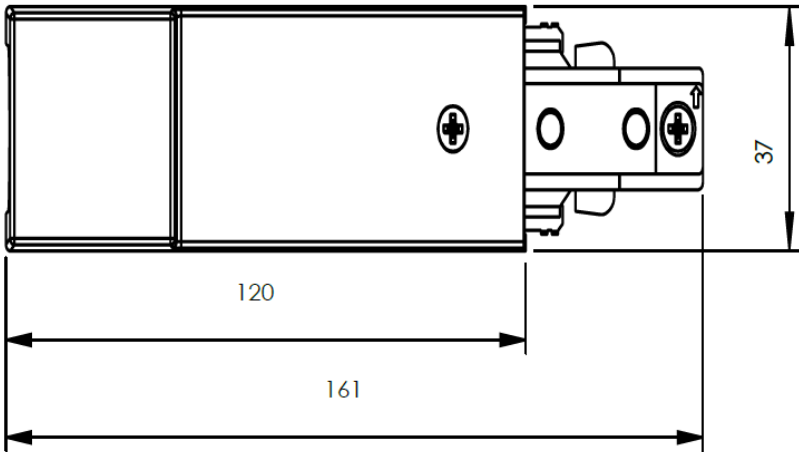

TRACK T10007

TRACK ACCESSORIES & SYSTEM

| | |
|--------------|--|
| DATE | |
| PROJECT NAME | |
| TYPE | |
| QTY | |
| NOTES | |

TRACK COMPONENTS

FLEXIBLE CONNECTOR



| Color | Ordering Code |
|--------|---------------|
| Black | T10007-BLK |
| White | T10007-WHT |
| Silver | T10007-SLV |

DIMENSIONS (in mm)

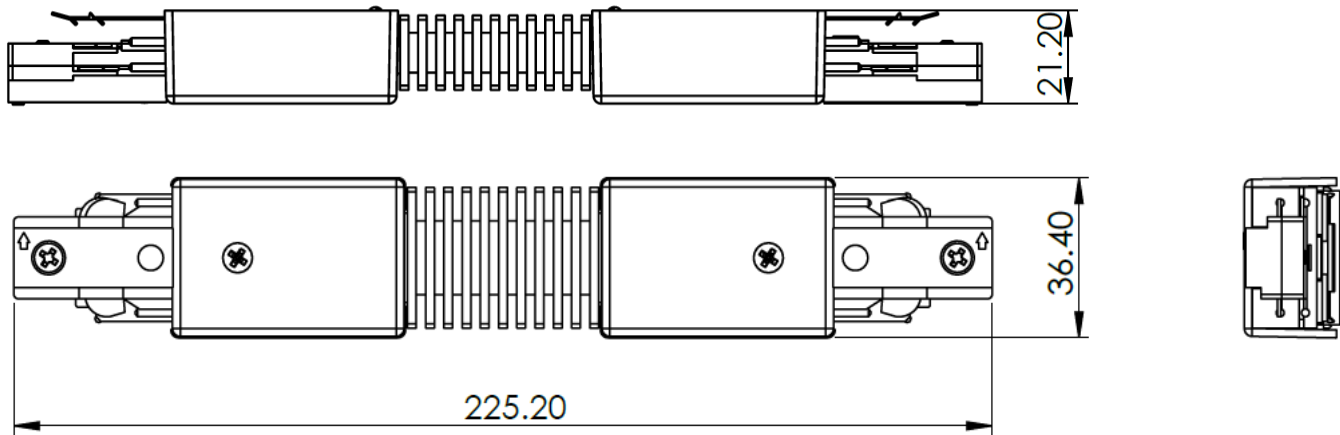

TRACK T10008

TRACK ACCESSORIES & SYSTEM

| | |
|--------------|--|
| DATE | |
| PROJECT NAME | |
| TYPE | |
| QTY | |
| NOTES | |

TRACK COMPONENTS

END FEED KIT + COVER



| Color | Ordering Code |
|--------|---------------|
| Black | T10008-BLK |
| White | T10008-WHT |
| Silver | T10008-SLV |

DIMENSIONS (in mm)

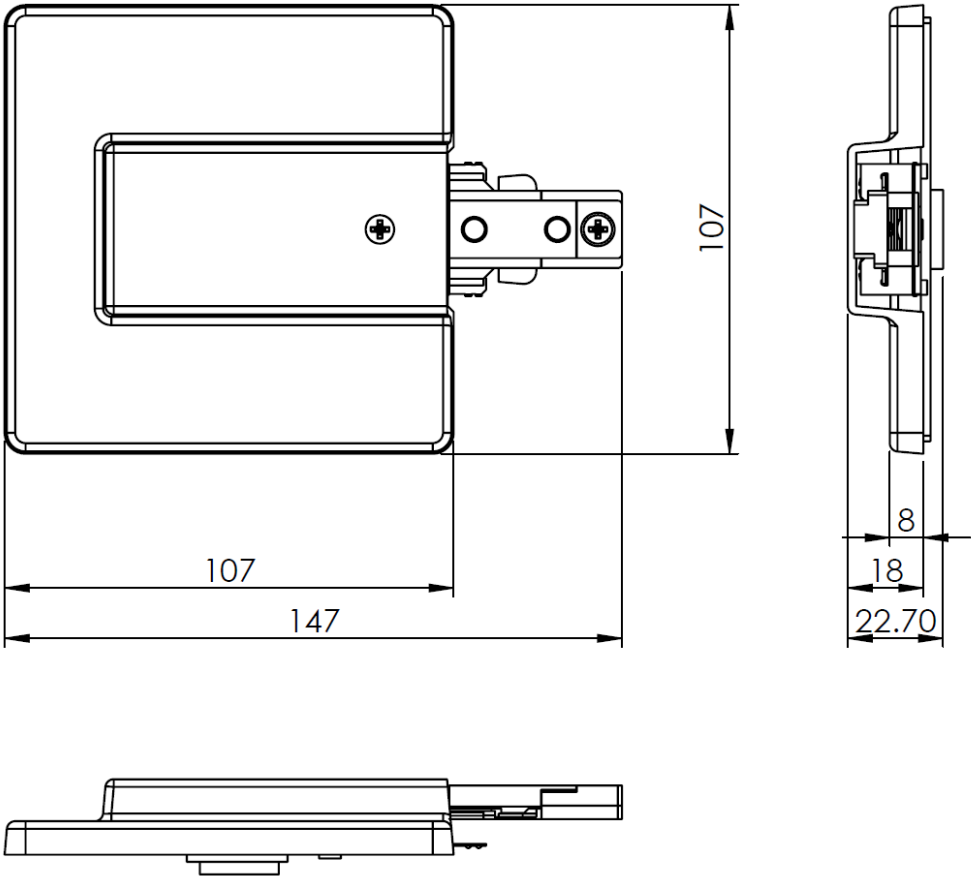

| | |
|--------------|--|
| DATE | |
| PROJECT NAME | |
| TYPE | |
| QTY | |
| NOTES | |

TRACK COMPONENTS

T-Bar Connector



| Color | Ordering Code |
|--------|---------------|
| Black | T10012-BLK |
| White | T10012-WHT |
| Silver | T10012-SLV |

DIMENSIONS (in mm)

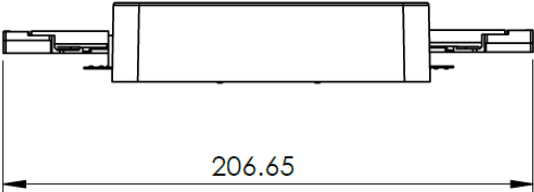
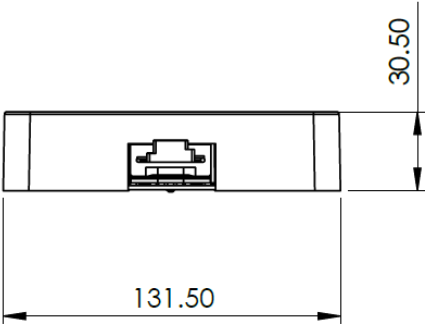
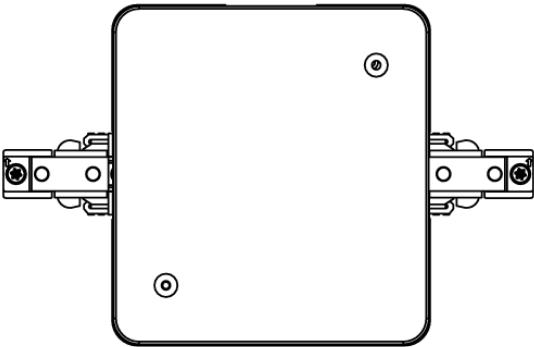

TRACK T10013

TRACK ACCESSORIES & SYSTEM

| | |
|--------------|--|
| DATE | |
| PROJECT NAME | |
| TYPE | |
| QTY | |
| NOTES | |

TRACK COMPONENTS

T-Bar End Feed



| Color | Ordering Code |
|--------|---------------|
| Black | T10013-BLK |
| White | T10013-WHT |
| Silver | T10013-SLV |

DIMENSIONS (in mm)

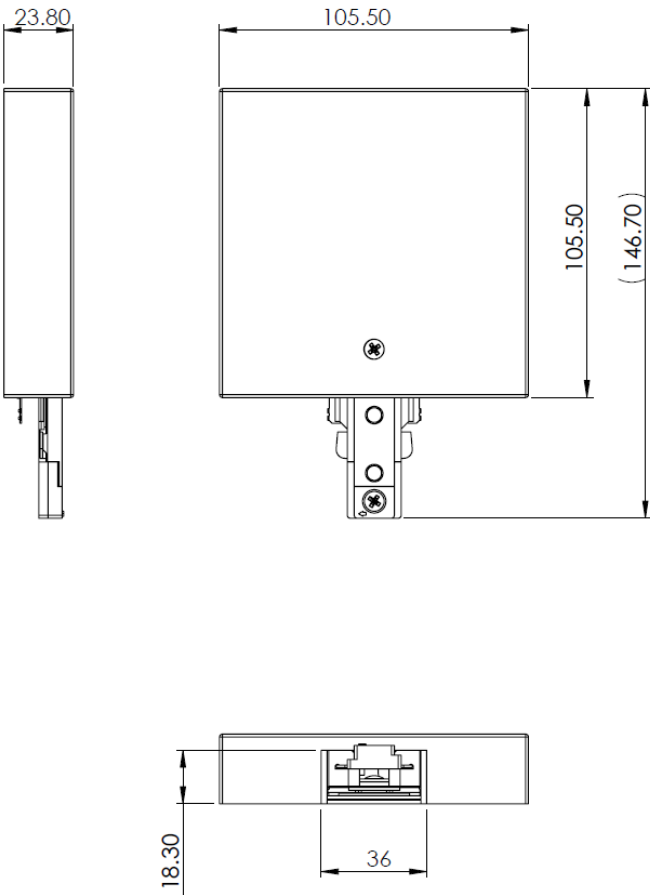

TRACK T10015

TRACK ACCESSORIES & SYSTEM

| | |
|--------------|--|
| DATE | |
| PROJECT NAME | |
| TYPE | |
| QTY | |
| NOTES | |

TRACK COMPONENTS

Top Access End Feed



| Color | Ordering Code |
|--------|---------------|
| Black | T10015-BLK |
| White | T10015-WHT |
| Silver | T10015-SLV |

DIMENSIONS (in mm)

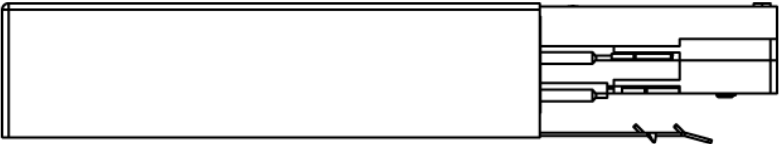
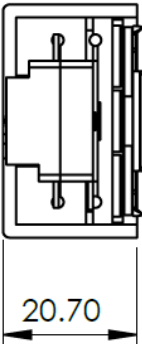
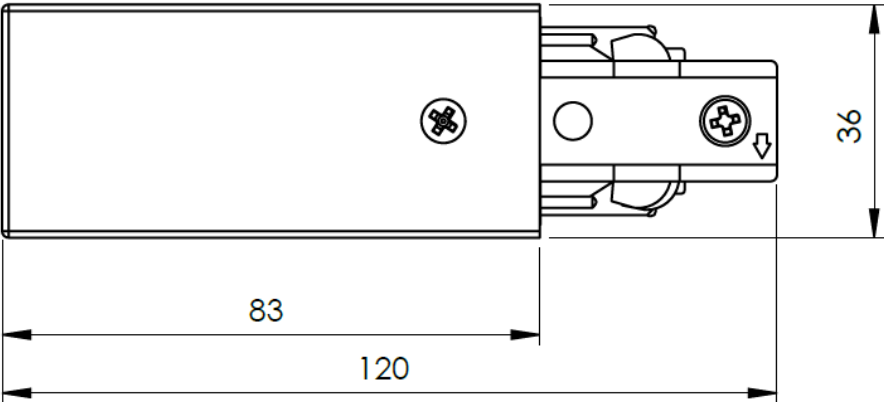

TRACK T10021

TRACK ACCESSORIES & SYSTEM

| | |
|--------------|--|
| DATE | |
| PROJECT NAME | |
| TYPE | |
| QTY | |
| NOTES | |

TRACK COMPONENTS

Single Circuit End Feed



| Color | Ordering Code |
|--------|---------------|
| Black | T10021-BLK |
| White | T10021-WHT |
| Silver | T10021-SLV |

DIMENSIONS (in mm)

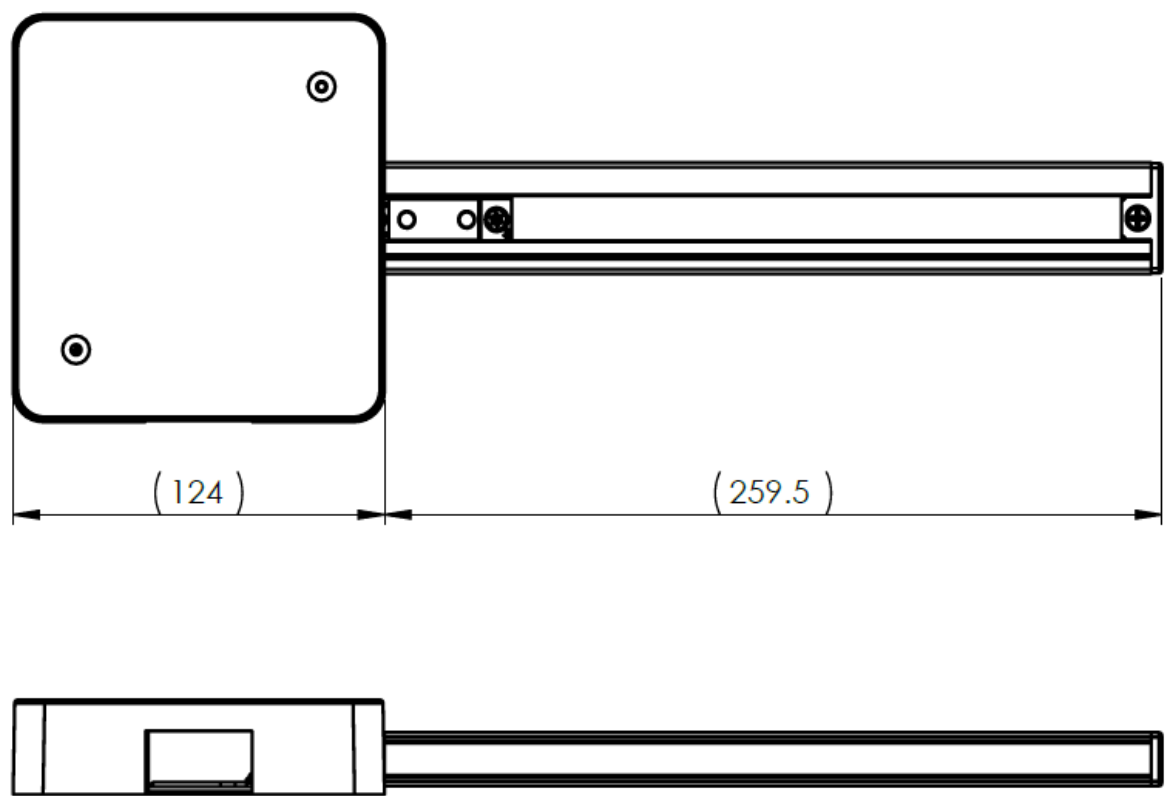

TRACK T10023

TRACK ACCESSORIES & SYSTEM

| | |
|--------------|--|
| DATE | |
| PROJECT NAME | |
| TYPE | |
| QTY | |
| NOTES | |

TRACK COMPONENTS

Single Circuit In-Line Feed



| Color | Ordering Code |
|--------|---------------|
| Black | T10023-BLK |
| White | T10023-WHT |
| Silver | T10023-SLV |

DIMENSIONS (in mm)

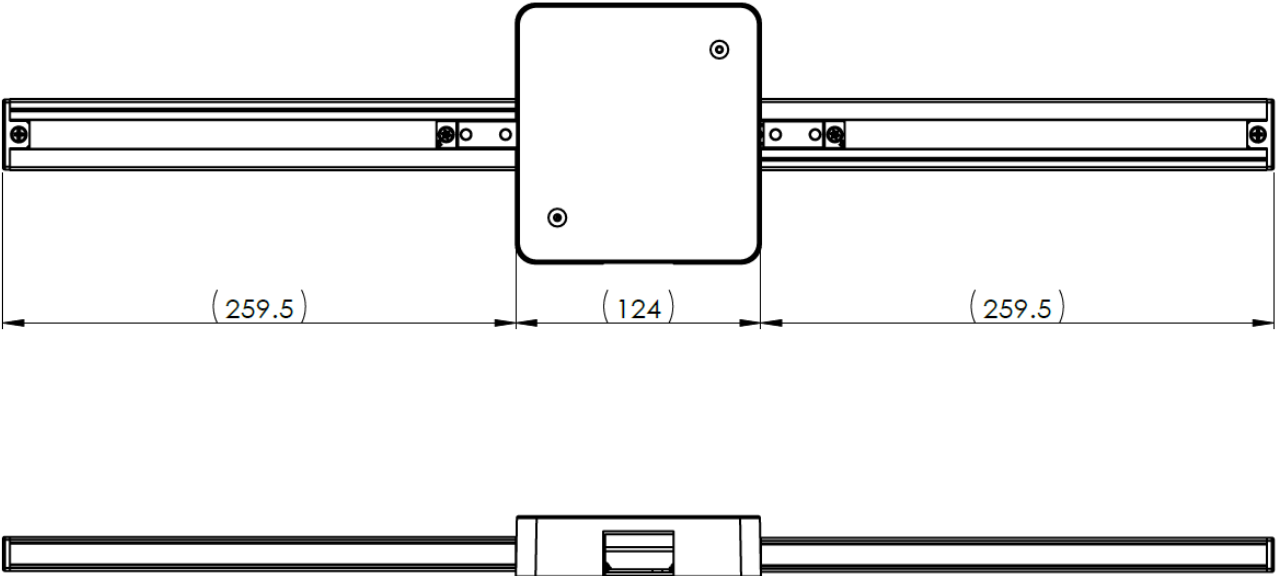

| | |
|--------------|--|
| DATE | |
| PROJECT NAME | |
| TYPE | |
| QTY | |
| NOTES | |

TRACK COMPONENTS

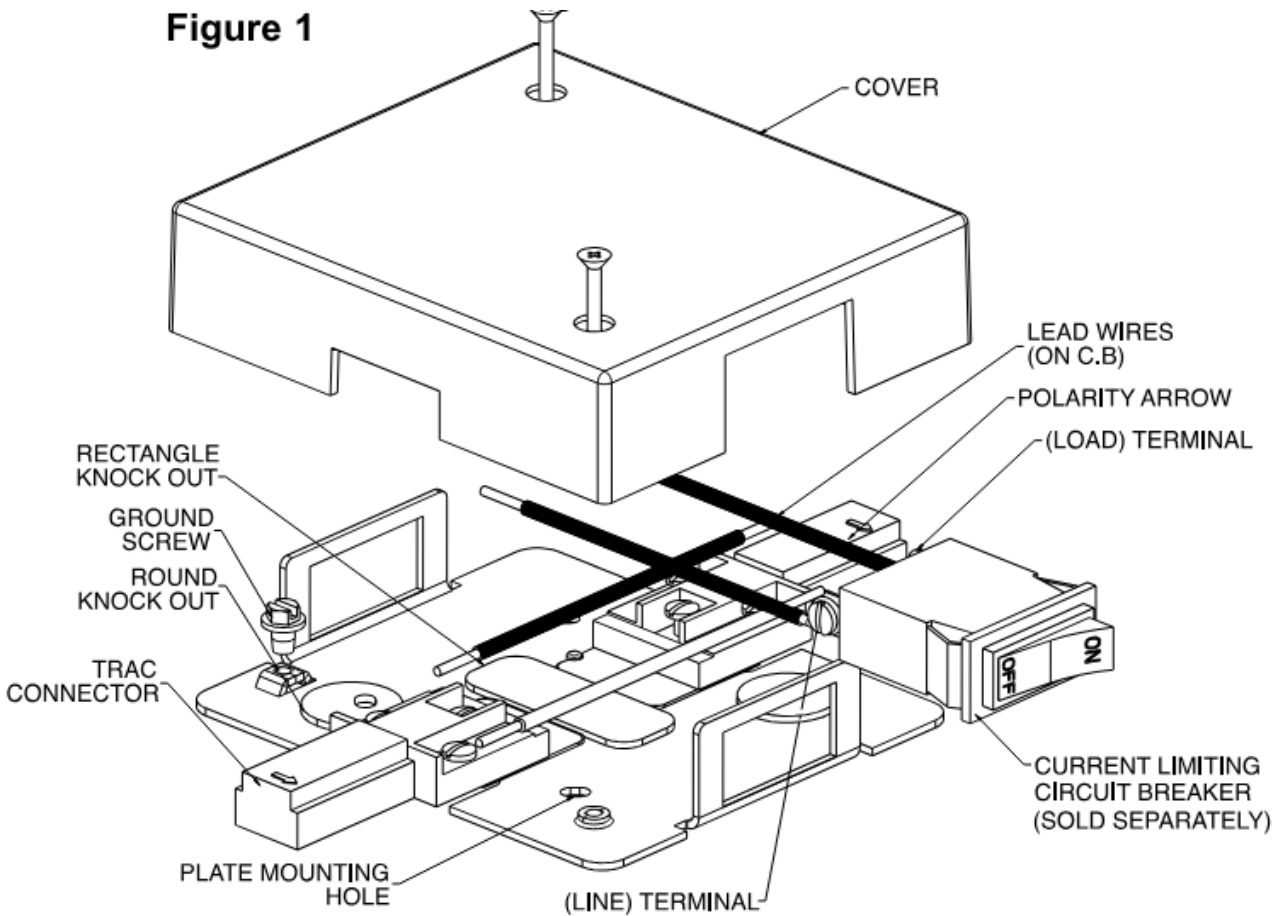

TRACK G-16TRK-SR

TRACK ACCESSORIES & SYSTEM

| | |
|--------------|--|
| DATE | |
| PROJECT NAME | |
| TYPE | |
| QTY | |
| NOTES | |

SUSPENSION TRACK WIRES

| TRACK SYSTEM SUSPENSION WIRE | SUSPENSION TYPE | SUSPENSION WIRE LENGTH |
|---|---------------------|--|
| G-16TRK-SR- | 44 Looped cable | -150 |
| G-16TRK-SR- 1/16" galv. cable, gripper & 8-32 bolt | CC Cable coupler | -150 150 inches length suspension wires |

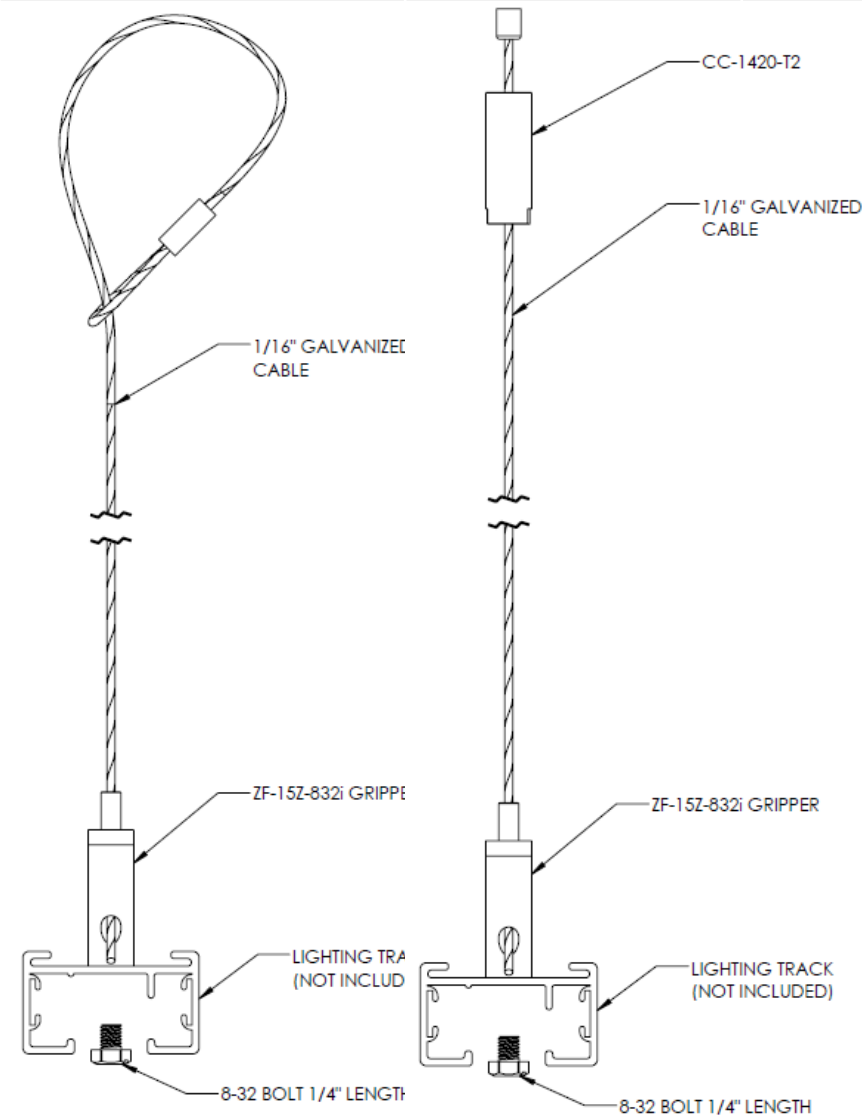

| | |
|--------------|--|
| DATE | |
| PROJECT NAME | |
| TYPE | |
| QTY | |
| NOTES | |

STEM KITS FOR SUSPENSION



CANOPY

| Color | Ordering Code |
|-------|---------------|
| Black | T10027-BLK |
| White | T10027-WHT |

STEM

| Ordering Code | Length |
|---------------|--------|
| TS48-WHT | 48" |
| TS48-BLK | 48" |
| TS36-WHT | 36" |
| TS36-BLK | 36" |
| TS24-WHT | 24" |
| TS24-BLK | 24" |
| TS12-WHT | 12" |
| TS12-BLK | 12" |

| | |
|--------------|--|
| DATE | |
| PROJECT NAME | |
| TYPE | |
| QTY | |
| NOTES | |

RECESSED TRACK HOUSING

TRACK ACCESSORIES & CONNECTIONS

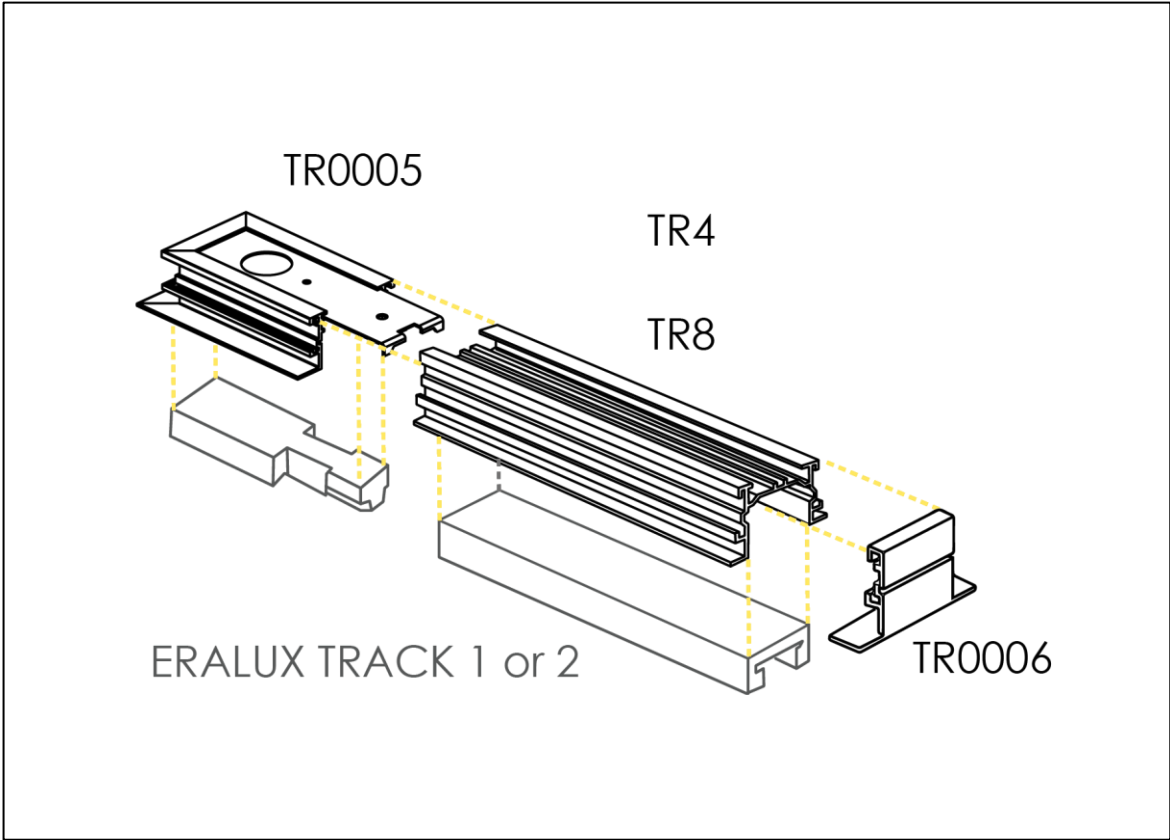

| FAMILY | LENGTH | FINISH |
|---|------------------------|-----------------------|
| TR- | | - |
| TR- ERALUX TR reversed circuit Juno compatible track systems | 4 4' Track System | -WHT White Finish |
| | 8 8' Track System | -BLK Black Finish |
| | 12 12' Track System | -SLV Silver Finish |

| | |
|--------------|--|
| DATE | |
| PROJECT NAME | |
| TYPE | |
| QTY | |
| NOTES | |

RECESSED TRACK HOUSING

Track Components

RECESSED HOUSING FOR I CONNECTOR



| Color | Ordering Code |
|--------|---------------|
| Black | TR0001-BLK |
| White | TR0001-WHT |
| Silver | TR0001-SLV |

RECESSED HOUSING FOR T CONNECTOR



| Color | Ordering Code |
|--------|---------------|
| Black | TR0002-BLK |
| White | TR0002-WHT |
| Silver | TR0002-SLV |

RECESSED HOUSING FOR T CONNECTOR



| Color | Ordering Code |
|--------|---------------|
| Black | TR0003-BLK |
| White | TR0003-WHT |
| Silver | TR0003-SLV |

| | |
|--------------|--|
| DATE | |
| PROJECT NAME | |
| TYPE | |
| QTY | |
| NOTES | |

RECESSED TRACK HOUSING

Track Components

RECESSED HOUSING FOR END FEED



| Color | Ordering Code |
|--------|---------------|
| Black | TR0005-BLK |
| White | TR0005-WHT |
| Silver | TR0005-SLV |

RECESSED HOUSING FOR END PIECE



| Color | Ordering Code |
|--------|---------------|
| Black | TR0006-BLK |
| White | TR0006-WHT |
| Silver | TR0006-SLV |