

MICHELANGELO

OUTDOOR PRODUCTS

Bollard

The MICHELANGELO bollard is an elegant solution for your outdoor area lighting needs. Its robust and strong materials allow it to withstand the harshest of elements without a scratch. The Michelangelo features an innovative optical system providing illumination to your space while keeping the beam shielded from the eye.



eralux®



DATE						
PROJECT NAME						
TYPE						
QTY						
ORDERING CODE	AE-OD-ML	-	-	-80	-	-

OPERATING & ELECTRICAL

INPUT VOLTAGE	120-240Vac 120-277Vac
POWER FACTOR	0.9
DIMMING	No dimming
TOTAL HARMONIC DISTORTION (THD)	<20%

MECHANICAL & HOUSING

SIZE	42" height
HOUSING	Corrosion-resistant aluminum-cast housing and plate for mounting. Concrete anchor for mounting.
LENS	36° optical polymer Polycarbonate lens
FINISH	Thermoset powder coat finish that provides superior resistance to corrosion and weathering. Minimum 3mm thickness for a finish that provides anti-cracking and peeling from weather further enhanced with a marine grade corrosion resistant coat.

PERFORMANCE OPTIONS

GFCI OPTION	Factory installed GFCI provision and in-use cover in the side of the luminaire 15A, 125V
-------------	---

APPLICATION CONDITION

AMBIENT TEMPERATURE RANGE	-25 to 50°C
Protection	IP65, thermally-insulated driver

COMPATIBLE MOUNTING

MOUNTING	Concrete anchor mounted on aluminum-cast plate
----------	--

WARRANTY

SYSTEM WARRANTY – 5 YEARS

Eralux will warrant defective drivers, LEDs and boards for 5 years from the date of purchase. This warranty is valid only if the fixture is installed and used as per installation guides and specifications. If a defect is present, Eralux will send drivers and boards at no fee with a thorough replacement instructions along with instructions on the return of the defective parts back to Eralux.

LUMEN MAINTENANCE – L70 at 50,000 hours

Rated for 70% initial lumen output at 50,000 hours of operation, operated at 25°C ambient temperature; per guidelines published by the Illuminating Engineering Society (IES)

MICHELANGELO

OUTDOOR PRODUCTS

Bollard

DATE	
PROJECT NAME	
TYPE	
QTY	
ORDERING CODE	AE-OD-ML - - -80 - -

ORDERING GUIDE

EXAMPLE: AE-OD-ML27-C10-33-6-3-80-B-M

FIXTURE FAMILY	POWER & SIZE	CCT	CRI	HOUSING & FINISH	OPTION
AE-OD-ML	-	-	-80	-	
AE-OD-ML27 Outdoor products Michelangelo Bollard Fixture	-C10-33-6 120-240Vac 10 watts: 400 lumens 33" height; 6" diameter	-3 3000K CCT	-80 80 CRI	-B-M Thermoset powder coat graphite black aluminum-cast housing with marine corrosion resistant finish	-BLANK No Option
AE-OD-ML28 Outdoor products Michelangelo Bollard Fixture	-C20-44-8 120-277Vac 20 watts: 1225 lumens 44" height; 8" diameter	-4 4000K CCT		-Z-M Thermoset powder coat mineral bronze aluminum-cast housing with marine corrosion resistant finish	
	-C35-44-8 120-277Vac 32 watts: 1960 lumens 44" height; 8" diameter	-5 5000K CCT		-W-M ERALUX nebula white thermoset cast housing with marine corrosion resistant finish*	-GC GFCI Outlet Option
				-S-M Aluminum (RAL9006) thermoset cast housing with marine corrosion resistant finish*	

*Contact for lead-times and availability

PRODUCT DIMENSIONS

AE-OD-ML27, AE-OD-ML28

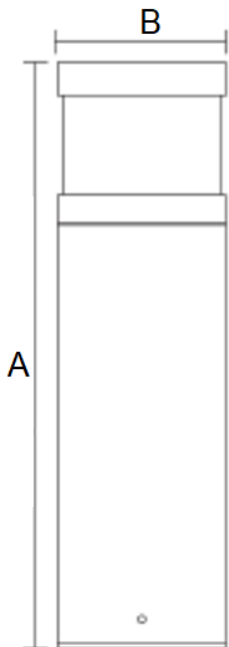

Product Dimensions

Power	A	B	C
10W	33" [838]	5.5" [140]	7.87" [200]
20W	42" [1067]	7.87" [200]	7.87" [200]
32W	42" [1067]	7.87" [200]	7.87" [200]

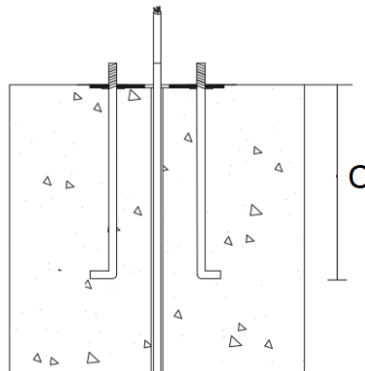

DATE						
PROJECT NAME						
TYPE						
QTY						
ORDERING CODE	AE-OD-ML	-	-	-80	-	-

B-U-G RATING

Power	BUG Rating
10W	B1-U3-G1
20W	B1-U3-G1
32W	B1-U3-G1

ANCHOR BOLT PATTERN

6-inch Base

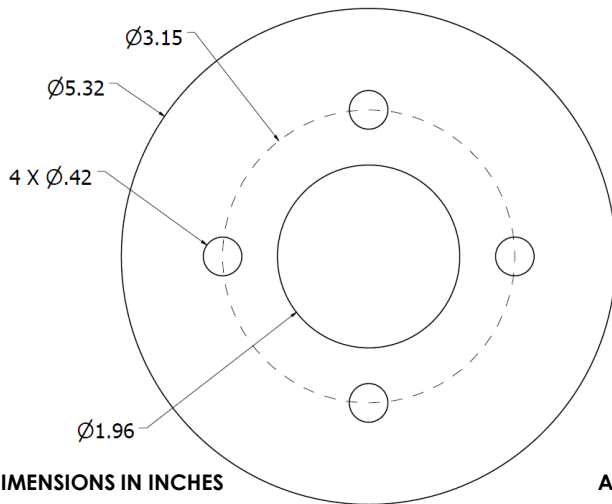

8-inch Base

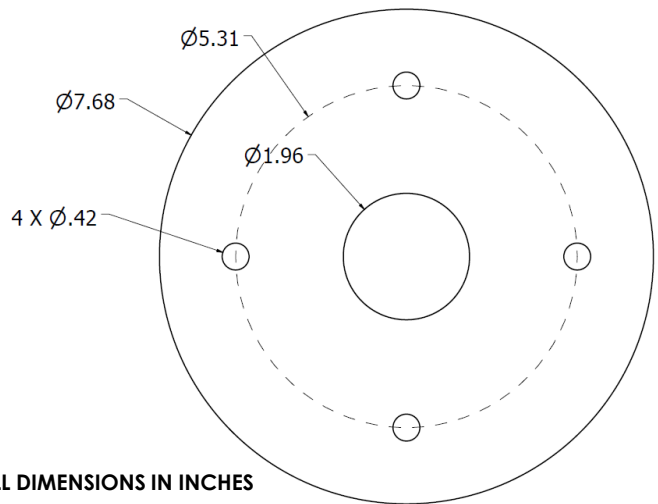

DATE						
PROJECT NAME						
TYPE						
QTY						
ORDERING CODE	AE-OD-ML	-	-	-80	-	-

GFCI OUTLET OPTION

Factory installed GFCI outlet option, output voltage 120V with safety flap.

Exterior cover easy locking system sealed from water intrusion.

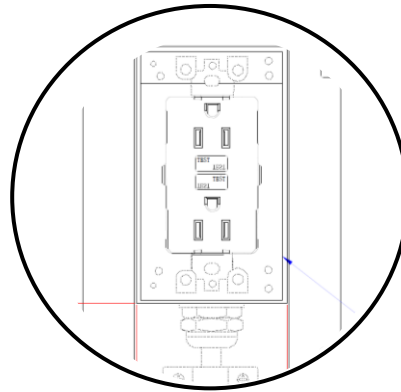
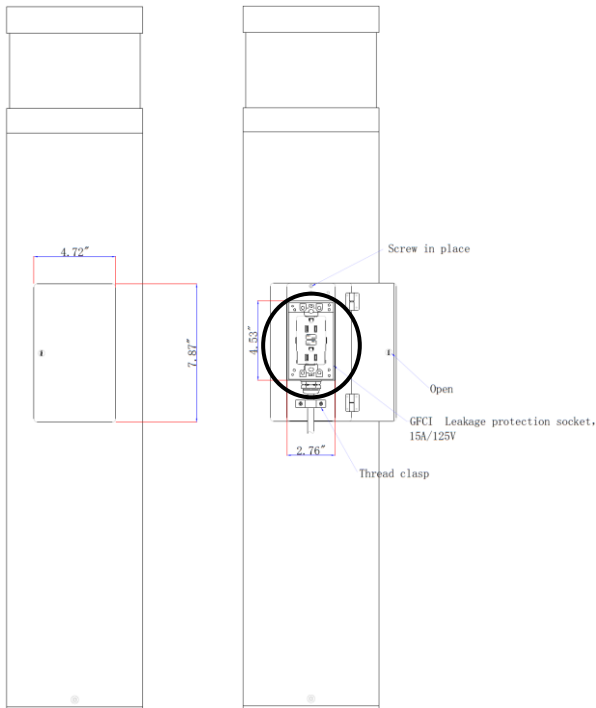

DATE					
PROJECT NAME					
TYPE					
QTY					
ORDERING CODE	AE-OD-ML	-	-	-80	-

LUMEN ESTIMATE

Lumen output varies based on CCT and CRI. An estimate of lumen output of the various CCT/CRI combinations, use correction factors as per table below:

LUMEN ESTIMATE ADJUSTMENT FACTORS				
CCT	2700K	3000K	3500K	4000K
NORMAL (70CRI)	0.91	0.94	0.97	1

PHOTOMETRIC DATA

AE-OD-ML27-C10-24-6-3-80-X-M

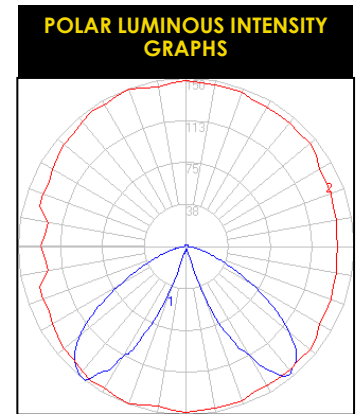
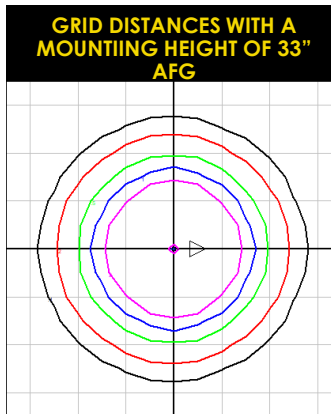

AE-OD-ML28-C20-44-8-3-80-X-M

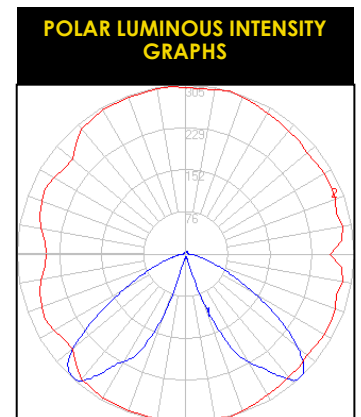
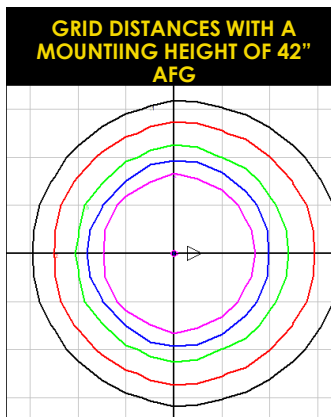

AE-OD-ML28-C35-44-8-3-80-X-M

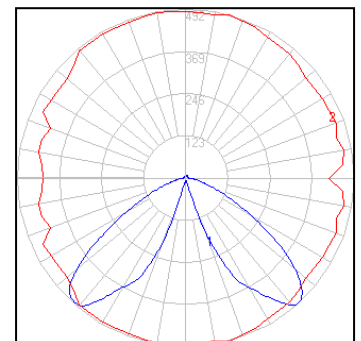
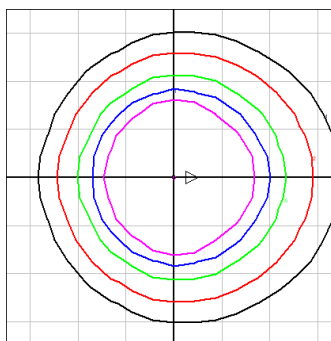

DATE						
PROJECT NAME						
TYPE						
QTY						
ORDERING CODE	AE-OD-ML	-	-	-80	-	-

OVERVIEW



44" height
8" diameter



33" height
6" diameter

MULTIPLE SIZES

Available in 6, and 8" diameter bore sizes, with heights of 33, and 44" depending on the lumen package selected.

PREMIUM MATERIALS

Aluminum die-cast housing and plate for enhanced thermal heat dissipation and structural integrity.

CORROSION RESISTANT FINISH

Thermoset powder coat finish combined with anti-cracking marine grade corrosion resistant finish to withstand harsh environmental conditions.

OPTICAL GLASS

360-degree optical polymer.