

SLIMA FIRE

LED COMMERCIAL DOWNLIGHT

Recessed Downlight



The **SLIMA Fire** Series LED downlight is the ideal recessed downlight for any retrofit or new construction project. The spring-action housing clips facilitates the installation process for any power option. The SLIMA Fire downlights has a selectable CCT switch enabling to change the color projection from 2700K to 5000K, offering an unparalleled level of flexibility. What makes such fixture unique is the capability of resisting fire.

eralux®



DATE	
PROJECT NAME	
TYPE	
QTY	
ORDERING CODE	AE-DL-SF- - -TRIAC-P2750-

OPERATING & ELECTRICAL

INPUT VOLTAGE	120V
POWER FACTOR	0.9
TOTAL HARMONIC DISTORTION(THD)	<20%

PERFORMANCE

LEMENS PER WATT	78 LPW at 80CRI
DIMMING	TRIAC
WATTAGE	9W
BEAM ANGLE	120°

MECHANICAL & HOUSING

HOUSING	Die casting aluminum for increased rigidity and strength
LENS	Highly durable polycarbonate and high transmittance lens
FINISH	White Black
POWER SUPPLY	Factory wired electronic LED driver
LED BOARD	Light emitted source

APPLICATION CONDITION

AMBIENT TEMPERATURE RANGE	-20 °C to 45°C
PROTECTION	Wet & Fire rated; IC rated

COMPATIBLE MOUNTING

MOUNTING	New construction or retrofit. Mounted with stainless steel spring-action housing clips
----------	-------------------------------------------------------------------------------------------

WARRANTY

SYSTEM WARRANTY – 5 YEARS

Eralux will warrant defective drivers, LEDs and boards for 5 years from the date of purchase. This warranty is valid only if the fixture is installed and used as per installation guides and specifications. If a defect is present, Eralux will send drivers and boards at no fee with a thorough replacement instructions along with instructions on the return of the defective parts back to Eralux.

LUMEN MAINTENANCE – L70 at 50,000 hours

Rated for 70% initial lumen output at 50,000 hours of operation, operated at 25°C ambient temperature; per guidelines published by the Illuminating Engineering Society (IES)

SLIMA FIRE

LED COMMERCIAL DOWNLIGHT
Recessed Downlight

DATE	
PROJECT NAME	
TYPE	
QTY	
ORDERING CODE	AE-DL-SF- - -TRIAC-P2750-

ORDERING GUIDE

FIXTURE FAMILY	SHAPE & SIZE	POWER	CONTROL	CCT	FINISH
AE-DL-SF-			TRIAC-	P2750	-
AE-DL-SF- SLIMA FIRE Series recessed downlight	04- 4" Round housing	09W- 9W:700 lumens	TRIAC- TRIAC dimming	P2750 Selectable CCT	BK Black finish
	06- 6" Round housing	14W- 14W:1100 lumens			WH White finish

* The 6" comes only with white finish

PRODUCT DIMENSIONS (in inches)

AE-DL-SF-04-09-TRIAC-P2750

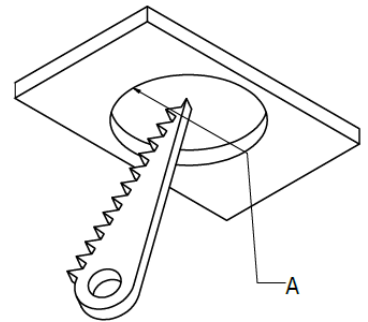
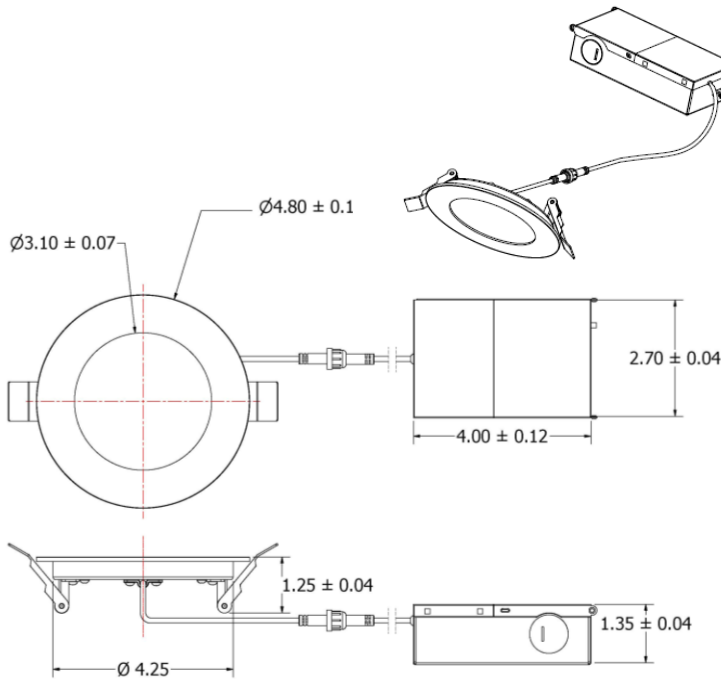

'A' represents the diameter of the hole in the ceiling; where A= 4.25 inches.

DATE	
PROJECT NAME	
TYPE	
QTY	
ORDERING CODE	AE-DL-SF- - -TRIAC-P2750-

Fire Rated Ceiling Assembly

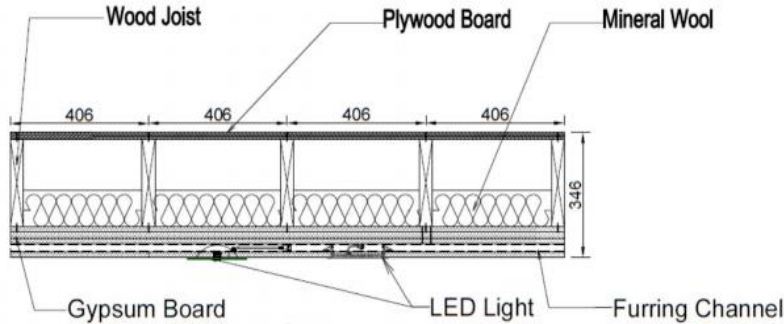

Assembly Description:

Use a 2-hour fire rated ceiling assembly constructed in accordance with construction specifications of UL Design No. L556. The nominal size of wood joist floor-ceiling assembly is 1680mm long by 1624mm wide by 338mm deep, consisted of wood joists, gypsum board, flooring, rock wool and was constructed at laboratory. The fire rated ceiling assembly consisting of the following:

Wood Joist

Five 1604mm long wood joists were to be positioned and secured to the wood bearing plates of 1624mm long with three M4.8x75mm Hexagon washer head self-tapping screws per wood joist end. The three staggered bridging of each row were to be positioned between wood joists and secured to the joists with three M4.8x75mm Hexagon washer head self-tapping screws per bridging end.

Flooring

One layer of 15mm plywood was placed on unexposed side of the wood frame along the direction of wood joists and fastened by ST3.5x35mm flat head self-tapping screws with a spacing of approximately 203mm in the perimeter and in the field.

Insulation

50mm thick rockwool was positioned into the cavity between wood joists above gypsum board.

Gypsum Board

Base layer 15mm Knauf gypsum board applied at right angles to the wood joists by ST3.5x35mm flat head self-tapping screws spaced 12" o.c. Second layer 15mm Knauf gypsum board applied at right angles to joists by ST3.5x50mm flat head self-tapping screws spaced 8" o.c. Second layer joints offset 32" from base layer joints. Third layer 15mm Knauf gypsum board applied at right angles to joists by ST3.5x64mm flat head self-tapping screws spaced 8" o.c. Third layer joints offset 16" from second layer joints. Five Hat-shaped rigid furring channels spaced 16" o.c. applied at right angles to joists over third layer with two ST3.5x64mm flat head self-tapping screws at each joist. Face layer 15mm Knauf gypsum wallboard applied at right angles to furring channels by ST3.5x35mm flat head self-tapping screws 8" o.c. The board joints and screws head were coated with 2 layers of joint compound.

Sample Installation:

Follow the manufacturer's installation instructions, cut a circular opening in the gypsum ceiling such that the annular space between the gypsum board and test specimen does not exceed 1/8 in. The test specimens were fixed to the face layer 15mm Knauf gypsum board of floor-ceiling assembly by spring clips.

SLIMA FIRE

LED COMMERCIAL DOWNLIGHT

Recessed Downlight

DATE	
PROJECT NAME	
TYPE	
QTY	
ORDERING CODE	AE-DL-SF- - -TRIAC-P2750-

ACCESSORIES

Ordered separately, field installed

NEW CONSTRUCTION UNIVERSAL FRAME KIT



MATERIAL 22-gauge galvanized steel housing.

MOUNTING T-bar or drywall ceilings
Up to 1.5" thick

Ordering Code AE-DL-FRKT-04-UNV
AE-DL-FRKT-06-UNV

FRAME KIT DIMENSIONS

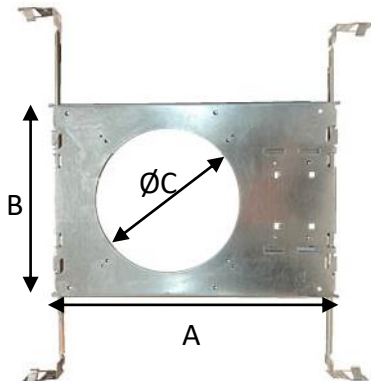

DIMENSIONS

	A	
4" Round	A	12.75" [324 mm]
	B	8.63" [219 mm]
	C	Ø 4.50" [114 mm]
6" Round	A	12.75" [324mm]
	B	8.63" [219 mm]
	C	Ø 6.37" [162 mm]
8" Round	A	12.75" [324mm]
	B	8.63" [219 mm]
	C	Ø 7.25" [184 mm]

LUMEN ESTIMATE

Lumen output varies based on CCT and CRI. An estimate of lumen output of the various CCT/CRI combinations, use correction factors as per table below:

LUMEN ESTIMATE ADJUSTMENT FACTORS

CCT	2700K	3000K	3500K	4000K	5000k
PREMIUM (90CRI)	0.96	1	1.03	1.06	1.06

SLIMA FIRE

LED COMMERCIAL DOWNLIGHT

Recessed Downlight

DATE	
PROJECT NAME	
TYPE	
QTY	
ORDERING CODE	AE-DL-SF- - -TRIAC-P2750-

ACCESSORIES (Continued)

Ordered separately, field installed

EMERGENCY LED DRIVER (BLD-HMXXD-YYY)

BLD-HM8D-YYY

OUTPUT POWER : 8 WATTS

BLD-HM25D-YYY

OUTPUT POWER : 25 WATTS



BLD-HMXXD-YYY series LED Emergency Driver is UL listed for field and factory installation that allows the same LED fixture to be used for both normal and emergency operation . In the event of a power failure , the emergency driver switches to emergency mode and operates the existing. Fixture to 90 minutes. The unit contains a battery , charge , and converter circuit in a single enclosure .This module will operate an LED array load at 6-25W with constant power at a rated output voltage of 170VDC. The constant power design of BLD-HMXXD-YYY maintains the output wattage to LED array, providing consistent illumination for entire emergency runtime. Ideal for use with most 0-10V dimmable indoor commercial LED lighting fixtures, such as LED flat panel, troffer, downlight and suspension mounting LED linear strip lights, etc.

Single Flex

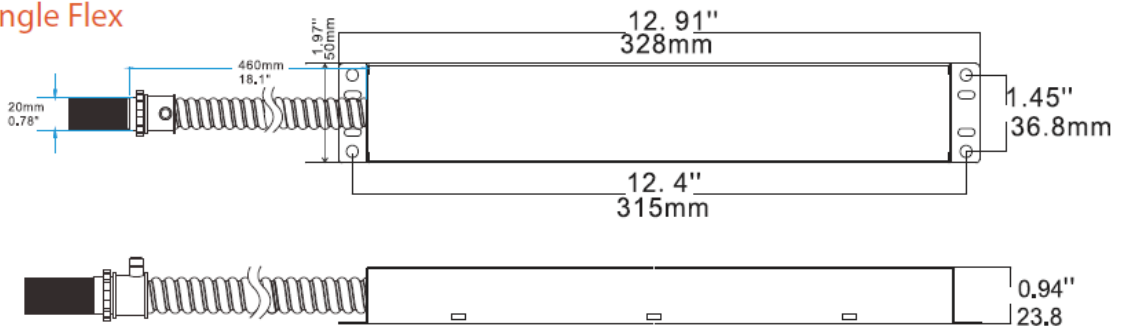

SLIMA FIRE

LED COMMERCIAL DOWNLIGHT

Recessed Downlight

DATE	
PROJECT NAME	
TYPE	
QTY	
ORDERING CODE	AE-DL-SF- - -TRIAc-P2750-

PHOTOMETRIC DATA

- AE-DL-SF-04-09W-triac-27K
- 4 INCH DIAMETER
- 2700K CCT
- 9 WATTS
- 700 LUMENS

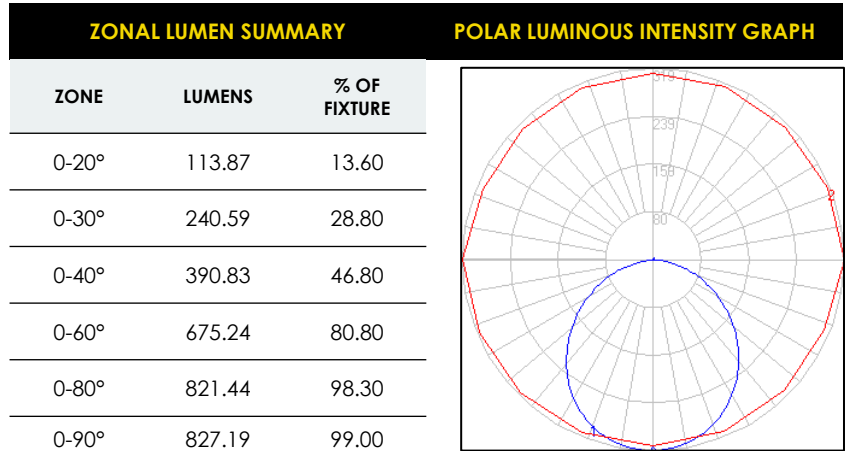

- AE-DL-SF-04-09W-triac-50K
- 4 INCH DIAMETER
- 5000K CCT
- 9 WATTS
- 700 lumens

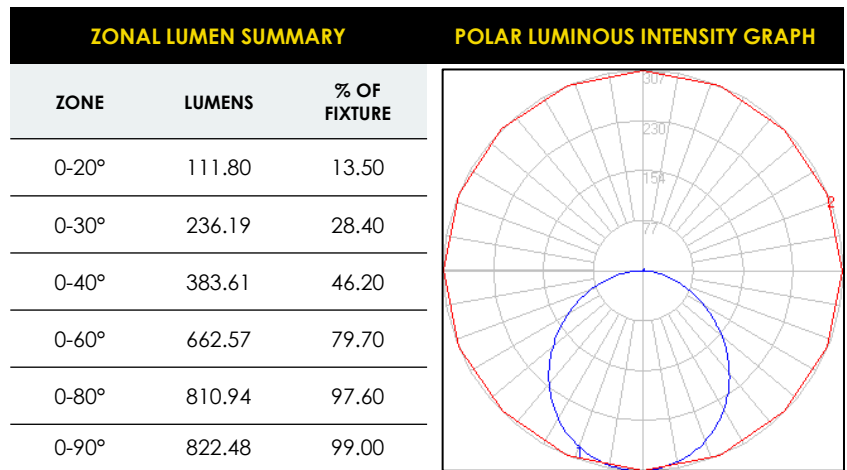

DIMMER COMPATIBILITY LIST

Dimmer: Low Line (120V/100V) TRIAc
LUTRON -S-600PR-WH
LUTRON-CTCL-153PR-WH
LUTRON-DVWCL-153PH-WH
LUTRON-DVCL-153PR-BL
LUTRON-TG600PR-LA

Dimmer: Low Line (120V/100V) TRIAc
LUTRON-TGCL-153PH-WH
LUTRON-CT600P-WH
LEVITON-6631-1LW
LEVITON-6674-POT
LEVITON-6672-1LW
LEVITON-6683-1W

SLIMA FIRE

LED COMMERCIAL DOWNLIGHT
Recessed Downlight

DATE				
PROJECT NAME				
TYPE				
QTY				
ORDERING CODE	AE-DL-SF-	-	-TRIAC-P2750-	

OVERVIEW

ULTRA-THIN PROFILE

The Fire Slim recessed downlight has a full thickness of just 1" allowing it to be used in a variety of application where fixture size and weight plays a decisive role.

SELECTABLE CCT

With a simple switch, the CCT can be changed to 2700K, 3000K, 3500K, 4000K or 5000K, offering an unparalleled level of flexibility.

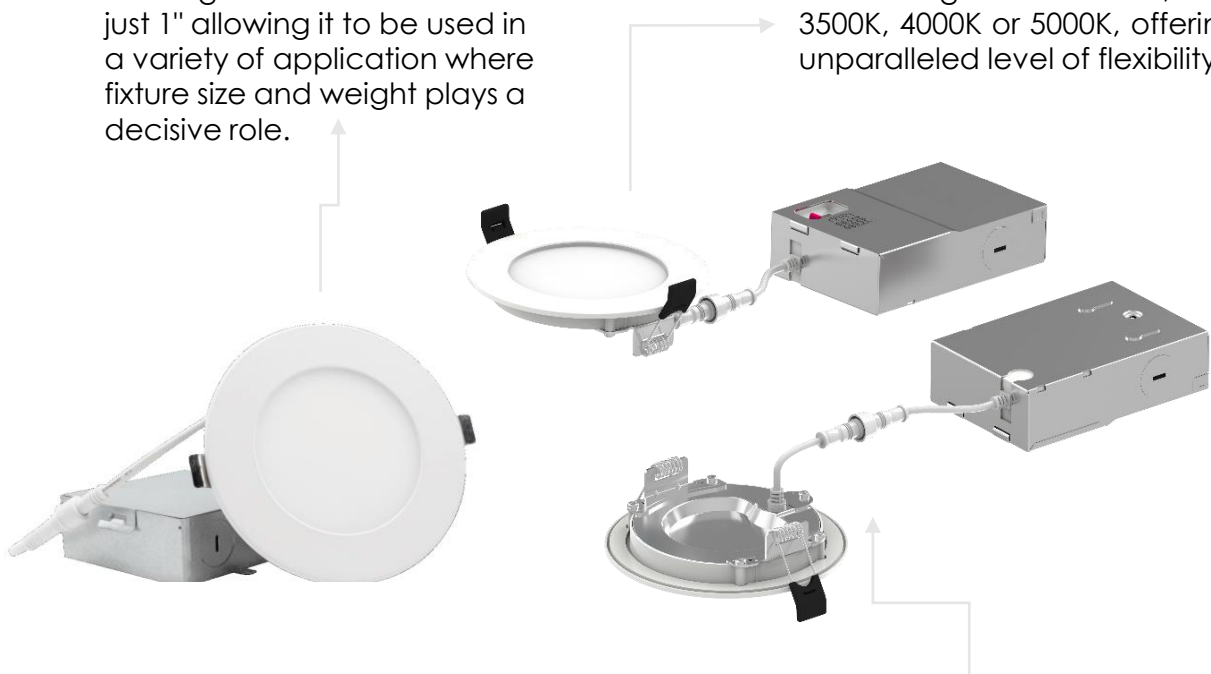

EASY INSTALLATION

Fixture comes standard with junction box allowing for excellent cable management reducing installation errors and potential maintenance, facilitating installation.

FIRE RATED

The fixture's housing expands when exposed to heat, preventing fire to expand throughout the ceiling. It lasts for 120 minutes.